

SPECIAL INCANDESCENT

JOB _____

TYPE _____

VOLTAGE _____

DARK ROOM SAFE LIGHT A LAMP

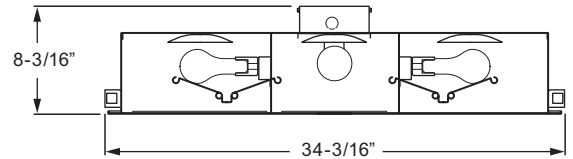
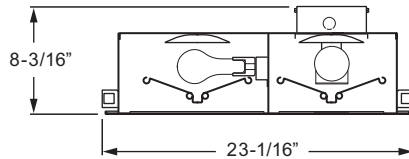
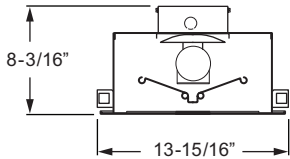
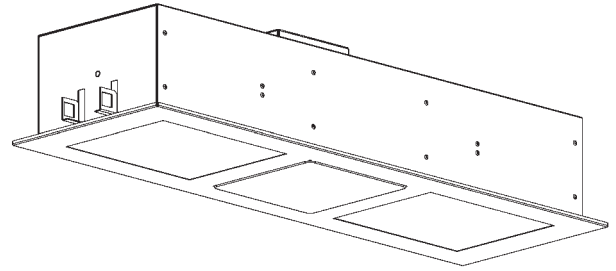
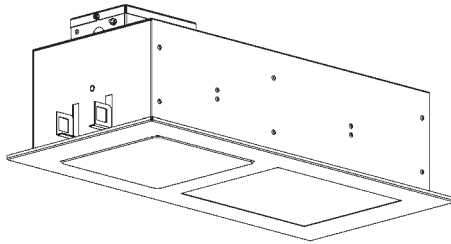
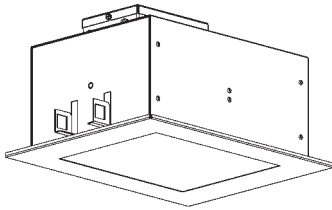

DRM1

CEILING CUT OUT:
12" x 9-1/4"

DRM2

CEILING CUT OUT:
21-1/8" x 9-1/4"

DRM3

CEILING CUT OUT:
32-1/4" x 9-1/4"

CATALOG NUMBER

SERIES	WATTAGE	LAMP BASE (SEE BELOW)	FILTER	VOLTAGE
DRM1	15	A15IF/MED		120
DRM2	150 ¹	A21IF/15-A15IF/MED		120
DRM3	150 ²	A21IF/(2)15-A15IF/MED		120

¹ For use with one 150-watt lamp and one 15-watt lamp (lamps not included).
² For use with one 150-watt lamp and two 15-watt lamps (lamps not included).

EXAMPLE: DRM1-15-A15IF/MED-OC-OPTIONS-120

OPTIONS & ADDERS

SUFFIX

Light amber filter	OC
Red filter	1
Dark red filter	2
Dark green filter	3
Amber filter	13
Red filter (most blue-sensitive X-ray films, most green-sensitive medical x-ray films)	GBX-2
Additional or replacement filters	COLOR
Tamper-resistant ³	TP ³
Fuse	F

³ This option requires a tamper-resistant tool (must be ordered separately). Please specify quantity required per project.

- Each filtered lamp compartment is socketed for 15-watt lamp (see options for available filters).
- DRM2 and DRM3 are socketed for one 150-watt lamp with clear prismatic tempered glass lens standard in addition to the 15-watt filtered compartment(s).
- Standard integral reflector/housing.
- Medium base porcelain socket.
- Housing and door steel construction.
- Adjustable mounting brackets.
- Prewired at factory for easy field installation.
- Black polyester powder paint.
- Lamp by others.
- UL/CUL listed for wet location under covered ceiling.
- This fixture is proudly made in the USA.

FIXTURE SUBMITTED/APPROVED



DOWNLIGHTING

