

2 OR 3 LAMP INJECTION-MOLDED **WRAP AROUND**

SERIES **31**
 VOLTAGE TYPE JOB _____

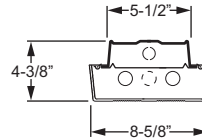
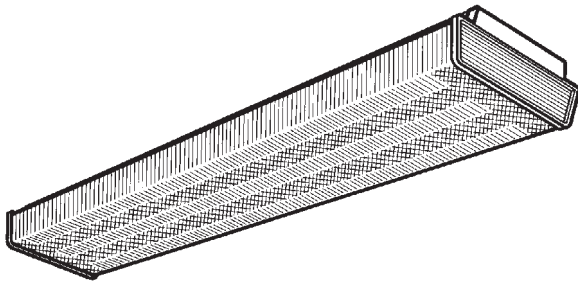

SPECIFICATIONS

- HOUSING – 20-gauge die-formed C.R.S.
- SHIELDING – Injection- molded clear acrylic prismatic diffuser standard or high-impact diffuser optional.
- FINISH – 92% minimum average reflective white powder coat with multi-stage iron/phosphate prepared metal.
- ELECTRICAL – Electronic ballast standard, instant start T8, rated Class P.
- LABELS – UL/CUL listed as fluorescent luminaire suitable for dry or damp locations.
- MOUNTING – Surface or suspended.

FEATURES

- Available with high-impact diffuser.
- Nearly 90% efficient.
- Injection-molded opaque white end caps provide decorative appearance and ensure long-term diffuser stability.
- Fully-enclosed spring-loaded barrel latches secure diffuser to fixture housing.
- Individual or continuous row mounting.
- Wireway is accessible without the use of tools.
- All parts painted after fabrication to facilitate installation, increase efficiency, and inhibit corrosion.
- This fixture is proudly made in the USA.

SUBMITTAL INFORMATION

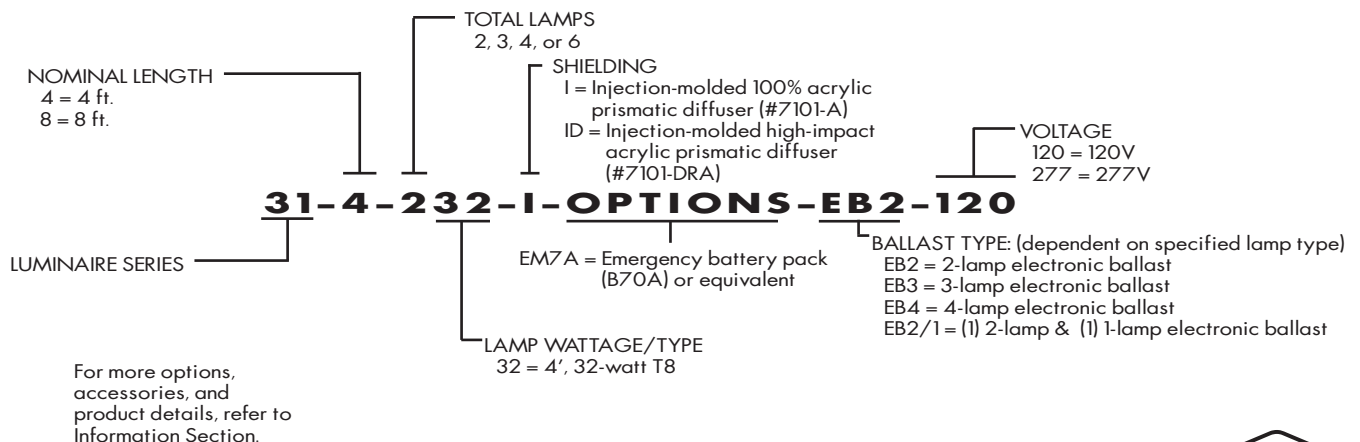

FLUORESCENT LIGHTING

Williams Catalog #31-4-232-I-EB2-120
Test Report #7869.0, Dated 2/28/94

Lamp Type: F32T8/735/RS
Lamp Quantity: 2

CANDLEPOWER DISTRIBUTION

VERT. ANG.	HORIZONTAL ANGLE			ZONAL LUMENS
	0	45	90	
0	1318.	1318.	1318.	
5	1325.	1325.	1329.	126.6
15	1319.	1341.	1365.	379.2
25	1176.	1280.	1404.	592.9
35	1014.	1364.	1604.	837.7
45	610.	1165.	1405.	854.3
55	192.	520.	610.	411.6
65	97.	231.	280.	229.7
75	73.	199.	226.	183.2
85	22.	133.	170.	130.7
90	0.	106.	167.	
95	1.	97.	217.	113.7
105	6.	122.	405.	185.5
115	12.	213.	335.	186.0
125	16.	183.	283.	146.8
135	19.	134.	208.	94.8
145	26.	90.	141.	54.3
155	26.	54.	76.	24.0
165	34.	40.	51.	11.7
175	29.	29.	29.	2.8
180	27.	27.	27.	

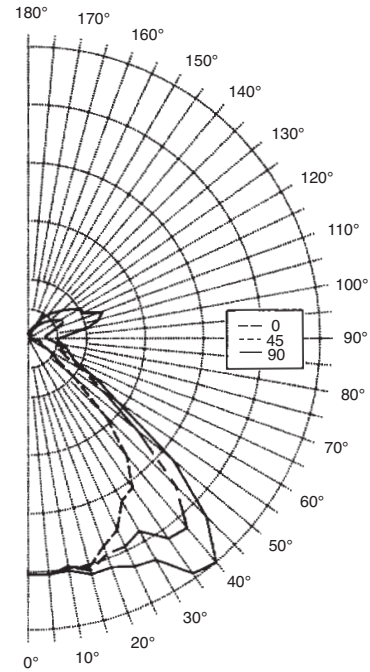

LUMEN SUMMARY

ZONE	LUMENS	% LAMP	% FIXTURE
0 - 30	1099.	19.3	24.1
0 - 40	1936.	34.0	42.4
0 - 60	3202.	56.2	70.1
0 - 90	3746.	65.7	82.0
90 - 120	485.	8.5	10.6
90 - 130	632.	11.1	13.8
90 - 150	781.	13.7	17.1
90 - 180	820.	14.4	18.0
Total Luminaire			
0-180	4565	80.1	100.0

ZONAL CAVITY COEFFICIENTS

EFFECTIVE FLOOR CAVITY REFL. = .20

CEILING	.80			.70			.50		
	.70	.50	.30	.70	.50	.30	.50	.30	.10
0	92	92	92	88	88	88	81	81	81
1	85	81	78	81	78	75	72	70	68
2	78	72	67	75	70	65	64	61	58
3	72	65	59	69	62	57	58	54	50
4	66	58	52	64	56	50	52	47	44
5	61	52	45	58	50	44	47	42	38
6	56	47	40	54	45	39	42	37	33
7	52	42	35	50	41	35	38	33	29
8	48	38	31	46	36	30	34	29	25
9	44	34	27	42	33	27	31	25	22
10	41	31	24	39	30	24	28	23	19

TOTAL LUMINAIRE

OPTICAL EFFICIENCY = **87.8 %**

SPACING CRITERIA: ACROSS= 1.8 ALONG= 1.2

BACK VIEW

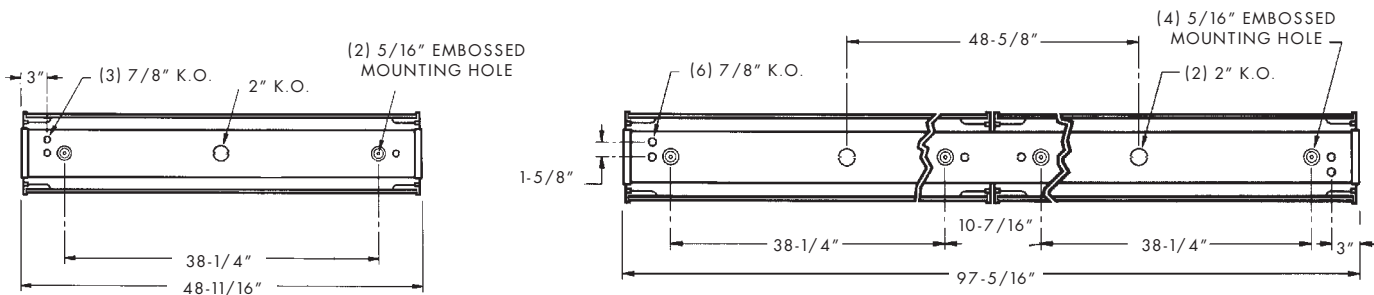

H. E. WILLIAMS, INC.

H.E. Williams, Inc. • Carthage, Missouri • www.hewilliams.com • 417-358-4065 • Fax: 417-358-6015

Information contained herein is subject to change without notice.

HEWJP42831 09/02/11RJ