

# 2 OR 3 LAMP INJECTION-MOLDED **WRAP AROUND**

SERIES **3 5**

VOLTAGE TYPE JOB \_\_\_\_\_  
 \_\_\_\_\_  
 \_\_\_\_\_

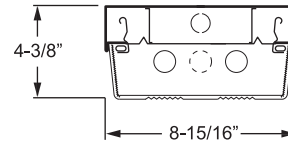
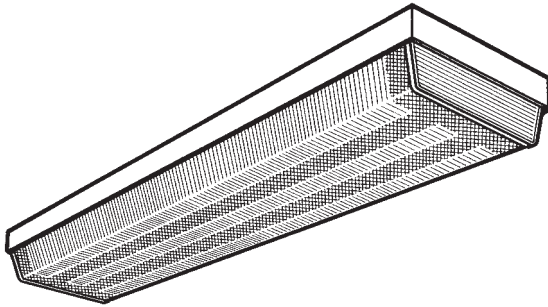

## SPECIFICATIONS

- HOUSING – 22-gauge die-formed C.R.S.
- SHIELDING – Injection-molded clear acrylic prismatic diffuser standard or high-impact diffuser optional
- FINISH – 92% minimum average reflective white powder coat with multi-stage iron/phosphate prepared metal.
- ELECTRICAL – Electronic ballast standard, instant start T8, rated Class P.
- LABELS – UL/CUL listed as fluorescent luminaire suitable for dry or damp locations.
- MOUNTING – Surface or suspended.

## FEATURES

- Captive self-centering spring steel latches secure diffuser.
- Injection-molded end caps add to decorative appeal.
- Wireway is accessible without the use of tools.
- Ballast secured by two captive bolts and nuts to ensure a tight, reliable fit for maximum heat dissipation and minimal ballast noise.
- All parts painted after fabrication to facilitate installation, increase efficiency, and inhibit corrosion.
- This fixture is proudly made in the USA.

## SUBMITTAL INFORMATION

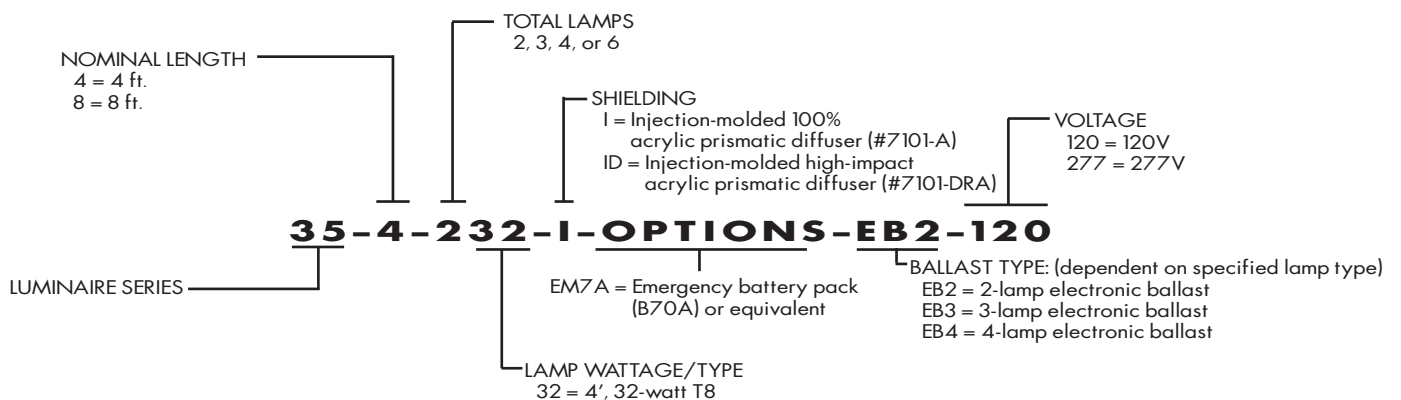

For more options, accessories, and product details, refer to Information Section.



FLUORESCENT LIGHTING

Williams Catalog #35-4-232-I-EB2-120  
 Test Report #8805.0, Dated 4/24/96

Lamp Type: F32T8/SPX35/RS  
 Lamp Quantity: 2

**CANDLEPOWER DISTRIBUTION**

VERT. ANG.	HORIZONTAL ANGLE			ZONAL LUMENS
	0	45	90	
0	1403.	1403.	1403.	
5	1409.	1402.	1395.	133.9
15	1415.	1433.	1485.	408.4
25	1269.	1424.	1627.	662.9
35	1059.	1512.	1812.	922.0
45	643.	1205.	1388.	876.0
55	229.	546.	626.	430.1
65	113.	242.	305.	244.2
75	79.	197.	253.	192.3
85	21.	136.	210.	143.3
90	0.	104.	202.	
95	0.	102.	274.	132.0
105	0.	127.	450.	197.8
115	0.	201.	299.	167.9
125	0.	111.	163.	85.3
135	0.	57.	93.	40.4
145	0.	50.	84.	28.9
155	0.	26.	46.	10.2
165	0.	0.	25.	2.5
175	0.	0.	0.	.0
180	0.	0.	0.	

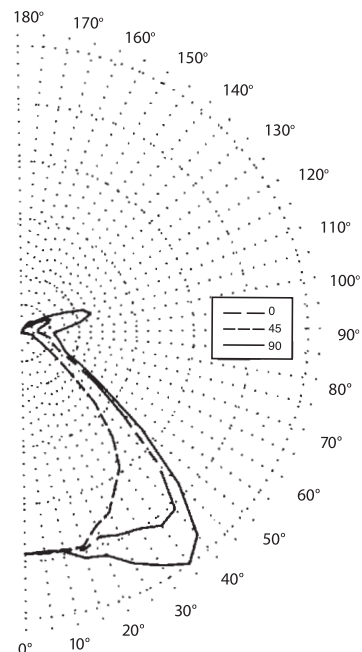

**LUMEN SUMMARY**

ZONE	LUMENS	% LAMP	% FIXTURE
0 - 30	1205.	20.4	25.8
0 - 40	2127.	36.1	45.5
0 - 60	3433.	58.2	73.4
0 - 90	4013.	68.0	85.8
90 - 120	498.	8.4	10.6
90 - 130	583.	9.9	12.5
90 - 150	652.	11.1	13.9
90 - 180	665.	11.3	14.2
Total Luminaire			
0-180	4678	79.3	100.0

**ZONAL CAVITY COEFFICIENTS**

EFFECTIVE FLOOR CAVITY REFL. = .20

CEILING	.80			.70			.50			
	WALL RCR	.70	.50	.30	.70	.50	.30	.50	.30	.10
0		92	92	92	88	88	88	82	82	82
1		84	81	78	81	78	75	73	71	69
2		78	72	67	75	70	65	65	62	59
3		72	65	59	69	63	57	59	54	51
4		66	58	52	64	56	51	53	48	44
5		61	52	46	59	50	45	48	43	39
6		57	47	40	54	46	40	43	38	34
7		52	42	36	50	41	35	39	34	30
8		48	38	32	46	37	31	35	30	26
9		44	34	28	42	33	27	31	26	22
10		41	31	25	39	30	24	28	23	20

**TOTAL LUMINAIRE**

OPTICAL EFFICIENCY = 79.3 %

SPACING CRITERIA: ACROSS= 1.7 ALONG= 1.2

**BACK VIEW**

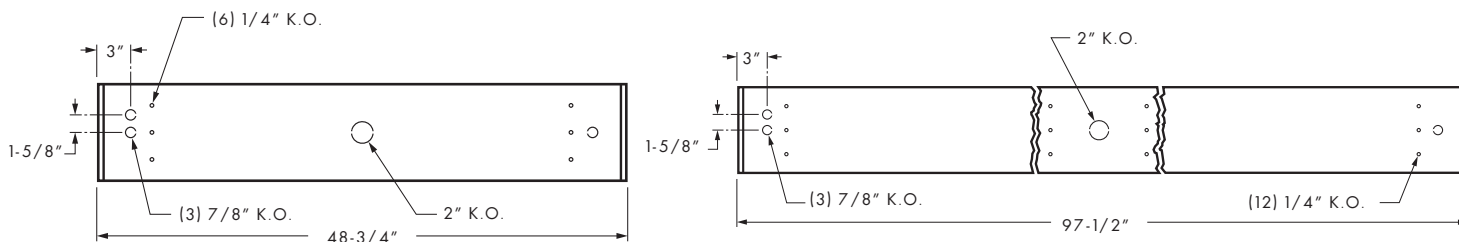

H. E. WILLIAMS, INC.

H.E. Williams, Inc. • Carthage, Missouri • [www.hewilliams.com](http://www.hewilliams.com) • 417-358-4065 • Fax: 417-358-6015

Information contained herein is subject to change without notice.

HEWJP42837 09/06/11RJ