

4' X 4' SURFACE MOUNT

SERIES **14**
 JOB _____
 TYPE _____
 VOLTAGE _____

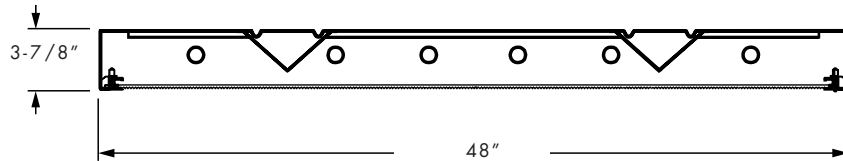
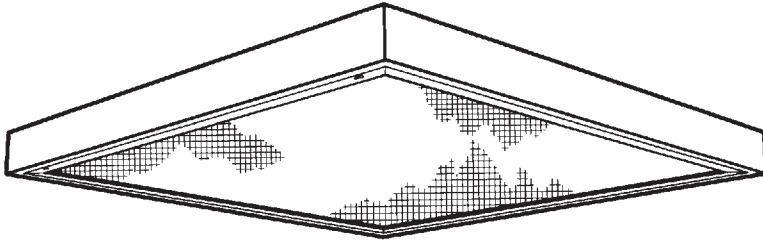

SPECIFICATIONS

- HOUSING – 20-gauge die-formed, welded C.R.S.
- DOOR FRAME – .050" extruded aluminum with mitered corners. Fully-enclosed spring-loaded cam latches and T-type hinges.
- SHIELDING – Clear acrylic prismatic lens standard.
- FINISH – 92% minimum average reflective white powder coat with multi-stage iron/phosphate prepared metal.
- ELECTRICAL – Electronic ballast standard, either instant start or programmed start, rated Class P.
- LABELS – UL/CUL listed as as fluorescent fixture suitable for dry or damp locations.
- MOUNTING – Surface or suspended.

FEATURES

- Fully-enclosed spring-loaded cam latches allow years of hassle-free maintenance.
- Mitered corners provide clean, crisp appearance with no visible rivets or screws.
- Welded end plates ensure durable, rigid construction.
- Fully gasketed door minimizes contaminants.
- Ballast secured by two captive bolts and nuts to ensure a tight, reliable fit for maximum heat dissipation and minimal ballast noise.
- All parts painted after fabrication to facilitate installation, increase efficiency, and inhibit corrosion.
- Deep back reinforcement ribs provide added strength.
- This fixture is proudly made in the USA.

SUBMITTAL INFORMATION

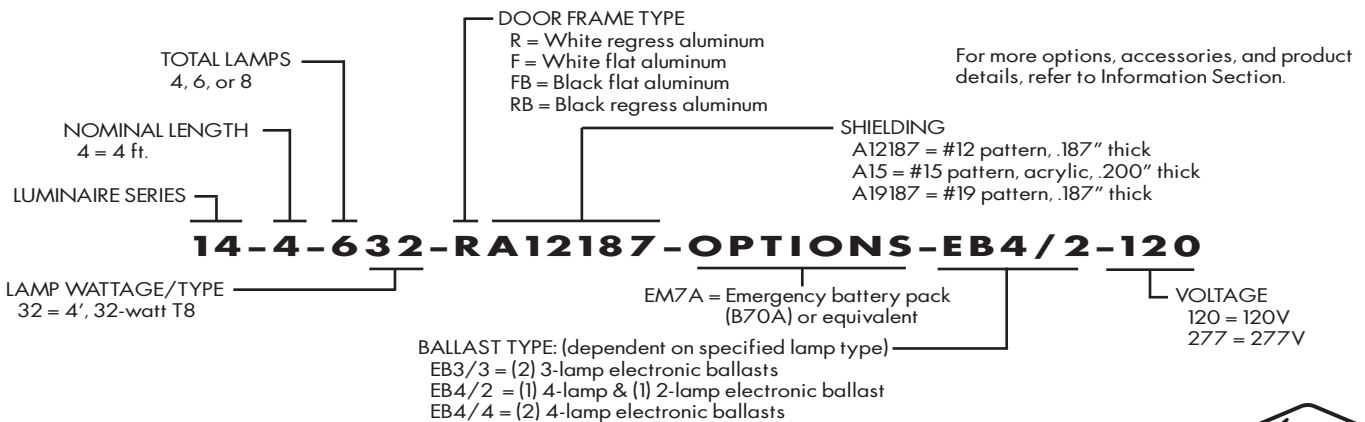

FLUORESCENT LIGHTING

Williams Catalog #14-4-632-FA12187-MB2/2/2-120 Lamp Type: F32T8/SPX35/RS
 Test Report #8454.0, Dated 10/05/95 Lamp Quantity: 6

CANDLEPOWER DISTRIBUTION

VERT. ANG.	HORIZONTAL ANGLE			ZONAL LUMENS
	0	45	90	
0	5904.	5904.	5904.	
5	5868.	5876.	5884.	561.7
15	5740.	5780.	5884.	1646.9
25	5208.	5424.	5624.	2509.6
35	4496.	4952.	5376.	3113.3
45	3560.	3792.	4384.	3018.0
55	1848.	2056.	2248.	1880.4
65	1096.	1016.	1176.	1030.3
75	624.	648.	696.	701.4
85	256.	240.	288.	288.0
90	0.	0.	0.	

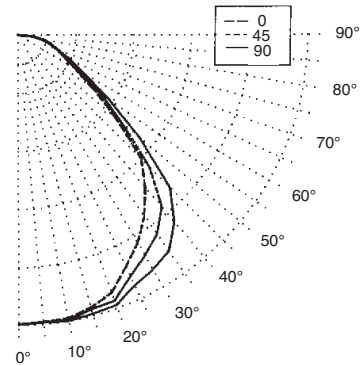

LUMEN SUMMARY

ZONE	LUMENS	% LAMP	% FIXTURE
0 - 30	4718.	26.7	32.0
0 - 40	7832.	44.2	53.1
0 - 60	12730.	71.9	86.3
0 - 90	14750.	83.3	100.0
90 - 120	0.	0.	0.
90 - 130	0.	0.	0.
90 - 150	0.	0.	0.
90 - 180	0.	0.	0.
Total Luminaire			
0-180	14750.	83.3	100.0

ZONAL CAVITY COEFFICIENTS

EFFECTIVE FLOOR CAVITY REFL. = .20

CEILING	.80			.70			.50			
	WALL	.70	.50	.30	.70	.50	.30	.50	.30	.10
0		.99	.99	.99	.97	.97	.97	.93	.93	.93
1		.92	.89	.85	.90	.87	.84	.83	.81	.79
2		.85	.79	.74	.83	.78	.73	.75	.71	.68
3		.79	.71	.65	.77	.70	.64	.67	.63	.59
4		.73	.64	.57	.71	.63	.57	.61	.56	.51
5		.67	.57	.50	.65	.56	.50	.55	.49	.45
6		.62	.52	.45	.60	.51	.44	.49	.44	.39
7		.57	.47	.40	.56	.46	.39	.45	.39	.35
8		.53	.42	.35	.51	.41	.35	.40	.34	.30
9		.48	.38	.31	.47	.37	.31	.36	.30	.26
10		.45	.34	.28	.44	.34	.27	.33	.27	.23

TOTAL LUMINAIRE

OPTICAL EFFICIENCY = **83.3 %**

SPACING CRITERIA: ACROSS= 1.4 ALONG= 1.2

BACK VIEW

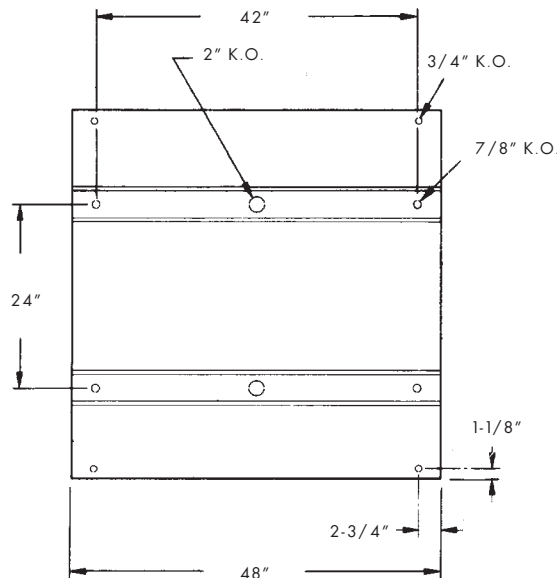

FLUORESCENT LIGHTING