

# SURFACE MOUNT OAK

SERIES **25-26**  
OAK

VOLTAGE TYPE JOB \_\_\_\_\_  
\_\_\_\_\_

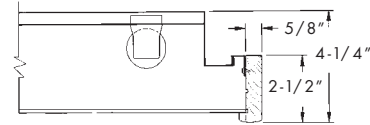
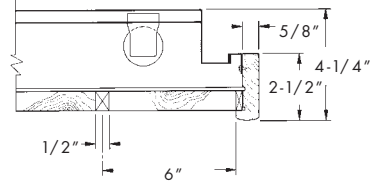
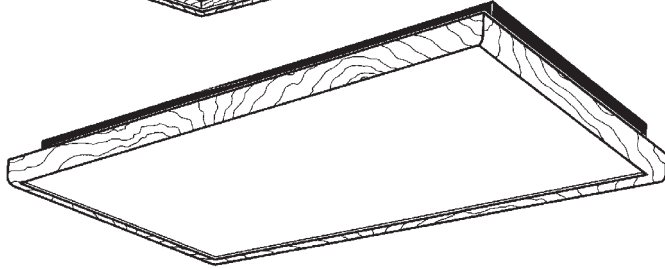
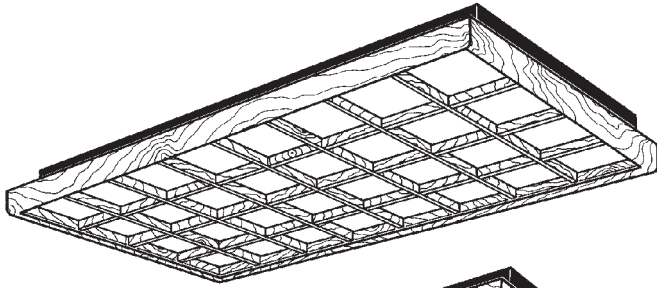

## SPECIFICATIONS

- HOUSING – 22-gauge die-formed C.R.S.
- FRAME – 5/8" thick solid oak wood with mitered corners and medium oak stain finish.
- SHIELDING – .080" matte white acrylic, clipped securely into wood frame.
- LATTICE – Optional 1/2" x 1/2" solid oak wood with medium oak stain finish. Lattice size is 6" x 6".
- EXTERIOR FINISH – Matte black finish on outer housing.
- REFLECTIVE SURFACES – 92% minimum average reflective white powder coat on interior steel components.
- ELECTRICAL – Electronic ballast standard, either instant start or programmed start, rated Class P.
- LABELS – UL/CUL listed as fluorescent luminaire suitable for dry or damp locations.
- MOUNTING – Surface or suspended.

## FEATURES

- In "lift & shift" fashion, diffuser removes easily from housing without tools.
- Oak frame combined with black painted steel housing creates a floating appearance.
- Ballast secured by two captive bolts and nuts to ensure a tight, reliable fit for maximum heat dissipation and minimal ballast noise.
- All parts painted after fabrication to facilitate installation, increase efficiency, and inhibit corrosion.
- This fixture is proudly made in the USA.

## SUBMITTAL INFORMATION

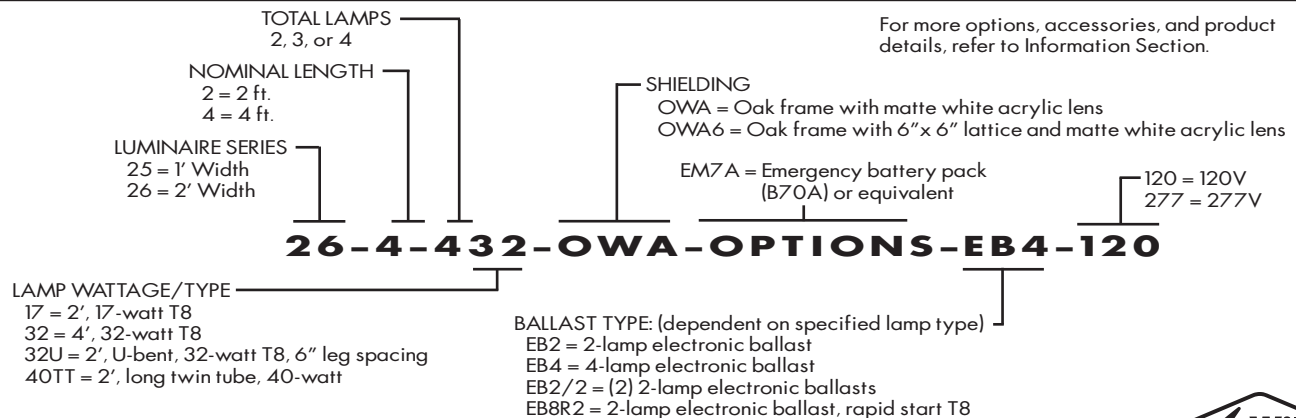

FLUORESCENT LIGHTING

**L A T T I C E F A C E V I E W**

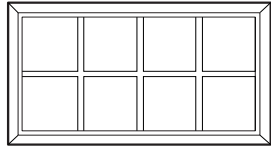

**Series 25**  
1' x 2'

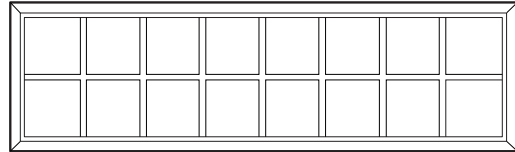

**Series 25**  
1' x 4'

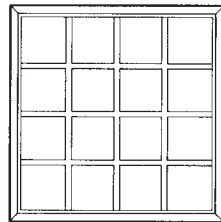

**Series 26**  
2' x 2'

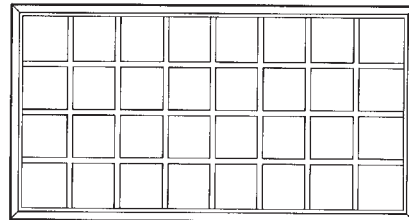

**Series 26**  
2' x 4'

**C R O S S S E C T I O N S**

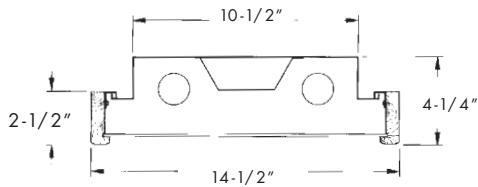

**SERIES 25**  
14-1/2" Wide Unit

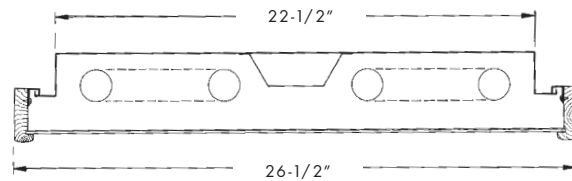

**SERIES 26**  
26-1/2" Wide Unit

**B A C K V I E W**

1' X 2'

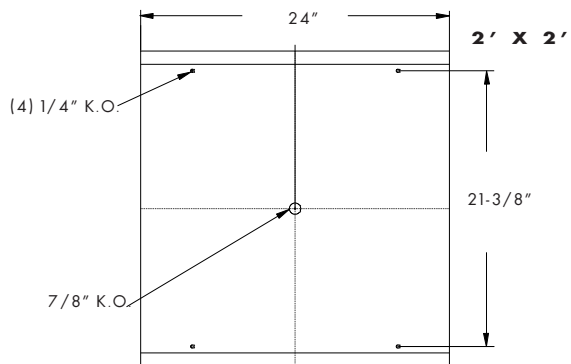
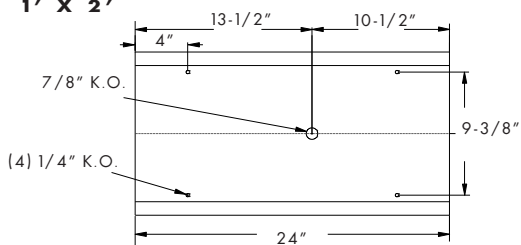

1' X 4'

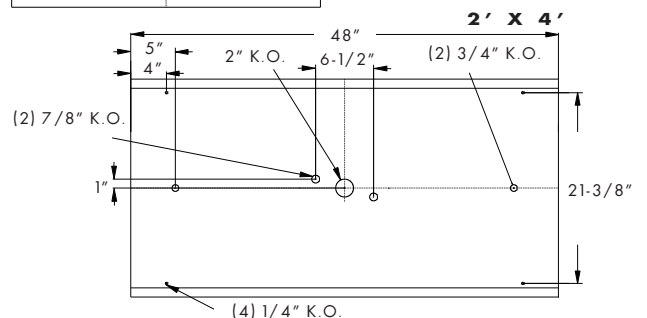
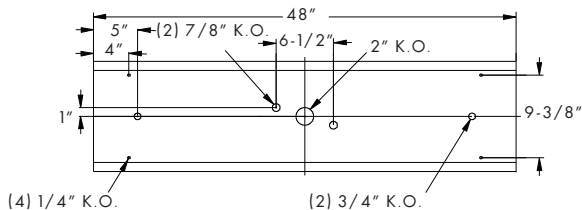

FLUORESCENT LIGHTING