

8" WIDE ARCHITECTURAL VANDAL WRAP

SERIES

AV8

VOLTAGE TYPE JOB

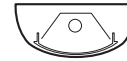
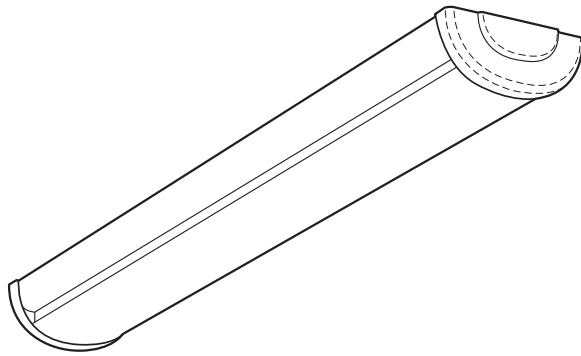

1 lamp

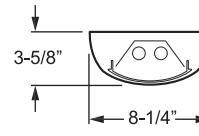

2 lamps

SPECIFICATIONS

- **HOUSING** – Extruded, marine grade aluminum with die-cast end caps.
- **SHIELDING** – .150" thick polycarbonate lens. Lens is secured to housing with multiple tamper-resistant tri-groove screws.
- **REFLECTIVE SURFACES** – 92% minimum average reflective white powder coat on interior components.
- **FINISH** – Non-glare white polyester powder coated exterior textured finish with multi-stage iron/phosphate prepared metal.
- **ELECTRICAL** – Electronic ballast standard, instant start T8, programmed start T5, rated Class P.
- **LABELS** – UL/CUL listed as fluorescent luminaire suitable for dry or damp locations. UL/CUL listed for wet location under covered ceiling when specified with WET/CC option (surface mount only).
- **MOUNTING** – Surface, pendant, or corner.

FEATURES

- Ideal for schools, hallways, dormitories, locker rooms, or any other vandal prone areas.
- Marine grade aluminum housing designed to withstand harsh environments.
- Tamper-resistant screws provided to protect against vandals (optional TPST 1/4" drive socket available). Standard phillips head screws also provided.
- Die-cast end caps envelop the diffuser for added strength and durability.
- Extremely durable damage-resistant polycarbonate lens is standard.
- Versatile mounting options include surface, pendant, or vandal-resistant corner mount.
- Features easy row mount capability with integral alignment pieces.
- All parts painted after fabrication to facilitate installation, increase efficiency, and inhibit corrosion.
- This fixture is proudly made in the USA.

ORDERING INFORMATION

Submittal

EXAMPLE: **AV8** - **4** - **2** **32** - **CPC** - **OPTIONS** - **EB2** - **UNV**

SERIES	AV8	Architectural Vandal Wrap, 8" wide
NOMINAL LENGTH	4 8	4' 8'
TOTAL LAMPS	1 or 2	
LAMP WATTAGE/TYPE	28T5S 32 54T5H¹	4', 28-watt T5 4', 32-watt T8 4', 54-watt T5HO ¹
SHIELDING	CPC WPC	Clear polycarbonate lens, .150" thick White polycarbonate lens, .150" thick

¹ T5H Fixtures are equipped with 90°C rated ballasts.

OPTIONS	EM packs must be low profile. Not available with generic EM ballast options.
WET/CC	Wet location under covered ceiling (surface mount only)
SWS(AV)12²	Pendant swivel stem mount with 12" stem ²
SS(AV)12²	Pendant stem mount with 12" stem ²
CMB	Vandal-resistant corner mount (For dry and damp location only)
C1B	Quick-connect, wiring harness, single circuit

² Two stem sets required for 4' fixture. One additional stem set required for each 4' length when row mounted.

BALLAST TYPE³	Ballast size restricted. Ballast and/or EM ballast sizes restricted to maximum ballast cross-section of 1-3/4" W. x 1-1/4" H.
EB1	1-lamp electronic ballast
EB2	2-lamp electronic ballast
VOLTAGE	120 120V 277 277V UNV 120 - 277V 347 347V

³ This fixture requires a tamper-resistant tool (must be ordered separately). Please specify quantity required per project.



FLUORESCENT LIGHTING

AV8

SERIES

PHOTOMETRY INFORMATION

Williams Catalog #AV8-4-232-CPC-EB2
 Test Report #13626.0, Dated 07/31/07

Lamp Type: F32T8/835/RS
 Lamp Quantity: 2

CANDLEPOWER DISTRIBUTION

VERT. ANG.	HORIZONTAL ANGLE			ZONAL LUMENS
	0	45	90	
0	1116.	1116.	1116.	
5	1113.	1113.	1113.	106.2
15	1099.	1128.	1165.	319.8
25	962.	1035.	1121.	480.2
35	794.	907.	1052.	575.7
45	631.	775.	1000.	617.1
55	443.	592.	870.	565.1
65	266.	436.	721.	465.2
75	102.	264.	519.	310.4
85	13.	135.	328.	172.8
90	1.	84.	233.	

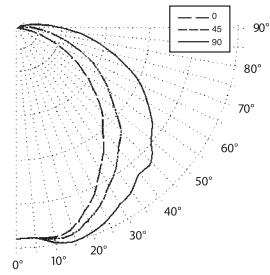

LUMEN SUMMARY

ZONE	LUMENS	% LAMP	% FIXTURE
0 - 30	906.	15.4	24.4
0 - 40	1482.	25.1	39.9
0 - 60	2664.	45.2	71.7
0 - 90	3613.	61.2	97.2
90 - 120	106.	1.8	2.8
90 - 130	106.	1.8	2.8
90 - 150	106.	1.8	2.8
90 - 180	106.	1.8	2.8
0 - 180	3718.	63.0	100.0

ZONAL CAVITY COEFFICIENTS

EFFECTIVE FLOOR CAVITY REFL. = .20

CEILING WALL RCR	.80			.70			.50		
	.70	.50	.30	.70	.50	.30	.50	.30	.10
0	.75	.75	.75	.73	.73	.73	.69	.69	.69
1	.68	.65	.62	.66	.63	.60	.60	.58	.56
2	.62	.56	.52	.60	.55	.51	.52	.49	.46
3	.56	.50	.44	.55	.48	.44	.46	.42	.39
4	.52	.44	.38	.50	.43	.38	.41	.37	.33
5	.47	.39	.33	.45	.38	.32	.36	.32	.28
6	.43	.35	.29	.42	.34	.28	.33	.28	.24
7	.40	.31	.25	.38	.30	.25	.29	.24	.21
8	.37	.28	.22	.35	.27	.22	.26	.22	.18
9	.34	.25	.20	.33	.24	.19	.24	.19	.16
10	.31	.23	.17	.30	.22	.17	.21	.17	.14

SPACING CRITERIA: END = 1.2 DIAG. = 1.3 ACROSS = 1.4

Williams Catalog #AV8-4-154T5H-CPC-EB1
 Test Report #13627.0, Dated 08/01/07

Lamp Type: FP54T5HO/835
 Lamp Quantity: 1

CANDLEPOWER DISTRIBUTION

VERT. ANG.	HORIZONTAL ANGLE			ZONAL LUMENS
	0	45	90	
0	876.	876.	876.	
5	880.	874.	874.	83.5
15	875.	894.	921.	253.6
25	765.	819.	885.	380.0
35	641.	725.	846.	461.3
45	510.	619.	807.	495.4
55	358.	482.	716.	461.1
65	213.	360.	607.	385.9
75	80.	231.	452.	269.0
85	9.	119.	292.	150.4
90	2.	77.	217.	

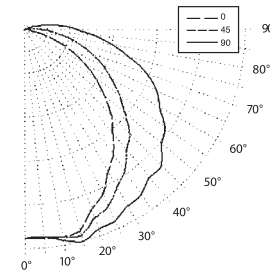

LUMEN SUMMARY

ZONE	LUMENS	% LAMP	% FIXTURE
0 - 30	717.	14.3	23.6
0 - 40	1178.	23.6	38.7
0 - 60	2135.	42.7	70.1
0 - 90	2940.	58.8	96.6
90 - 120	105.	2.1	3.4
90 - 130	105.	2.1	3.4
90 - 150	105.	2.1	3.4
90 - 180	105.	2.1	3.4
0 - 180	3045.	60.9	100.0

ZONAL CAVITY COEFFICIENTS

EFFECTIVE FLOOR CAVITY REFL. = .20

CEILING WALL RCR	.80			.70			.50		
	.70	.50	.30	.70	.50	.30	.50	.30	.10
0	.72	.72	.72	.70	.70	.70	.67	.67	.67
1	.65	.62	.59	.63	.61	.58	.58	.55	.53
2	.59	.54	.50	.57	.53	.49	.50	.47	.44
3	.54	.48	.42	.52	.46	.42	.44	.40	.37
4	.49	.42	.37	.48	.41	.36	.39	.35	.31
5	.45	.37	.31	.44	.36	.31	.35	.30	.26
6	.41	.33	.27	.40	.32	.27	.31	.26	.23
7	.38	.30	.24	.37	.29	.24	.28	.23	.20
8	.35	.27	.21	.34	.26	.21	.25	.20	.17
9	.32	.24	.19	.31	.23	.18	.22	.18	.15
10	.30	.22	.17	.29	.21	.16	.20	.16	.13

SPACING CRITERIA: END = 1.2 DIAG. = 1.3 ACROSS = 1.5

MOUNTING OPTIONS

Visit our website for detailed mounting instructions:
www.hewilliams.com



H.E. WILLIAMS, INC.

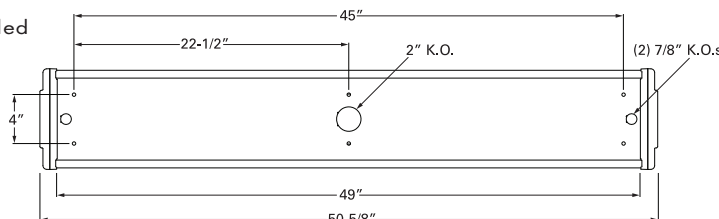

CMB Dry and damp location only

