

# INDIRECT PERIMETER WALL

# IPW

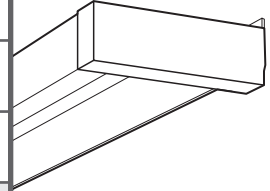

**SUBMITTAL:**

**JOB:**

**TYPE:**

**VOLTAGE:**

EXAMPLE

**IPW - 4 - 2 54T5H - OPTIONS - EB1/1 - UNV**

SERIES      NOMINAL LENGTH      TOTAL LAMPS      WATTAGE/TYPE      OPTIONS      BALLAST TYPE      VOLTAGE



## FEATURES

- ▶ Designed for asymmetric uplight and wall wash light distributions with independent switching standard.
- ▶ Extruded aluminum face plate for clean straight appearance.
- ▶ Extruded aluminum mounting rail and integral level adjustment allows for easy, accurate installation.
- ▶ Individual or continuous row mounting.
- ▶ Custom color options available.
- ▶ Uplight shielded with clear acrylic to prevent accumulation of dust and debris.
- ▶ Adjustable backsplash baffle controls uplight spill on wall.
- ▶ This fixture is proudly made in the USA.

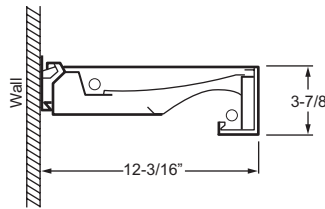

## SPECIFICATIONS

**Housing** – 22-gauge C.R.S. housing and end caps. Extruded aluminum mounting rail and face plate.

**Reflector** – 95% reflective highly specular aluminum.

**Finish** – Textured matte white polyester TGIC powder coat bonded to phosphate-free, multi-stage pretreated metal. All parts painted after fabrication to facilitate installation, increase efficiency, and inhibit corrosion.

**Electrical** – Electronic ballast standard, program start T5, rated Class P.

**Mounting** – Wall.

**Labels** – UL/CUL listed as fluorescent luminaire suitable for dry or damp locations.

## ORDERING INFORMATION

### SERIES

**IPW** Indirect Perimeter Wall

### NOMINAL LENGTH

**4** 4'  
**8** 8'

### TOTAL LAMPS

**2 or 4** (2-lamp cross-section)

### LAMP WATTAGE/TYPE

**28T5S** 4', 28-watt T5  
**54T5H** 4', 54-watt T5HO

### OPTIONS

For generic EM ballast options (must specify voltage), see Information section.

**C2** Two-circuit quick-connect wiring harness. For complete quick-connect offering, see Information section.

### BALLAST TYPE

**EB1/1** (2) 1-lamp electronic ballasts  
**EB2/2** (2) 2-lamp electronic ballasts

### VOLTAGE

**120** 120V  
**277** 277V  
**UNV** 120-277V  
**347** 347V



## TEST REPORT INFORMATION

- ▶ Test Report #: 13588.0
- ▶ Date: 05/24/07
- ▶ Lamp Type: FP54T5HO/835
- ▶ Lamp Quantity: 2

## PHOTOMETRY INFORMATION

Catalog #: IPW-4-254T5H

### CANDLEPOWER DISTRIBUTION

Vertical Angle	Horizontal Angle					Zonal Lumens
	0°	45°	90°	135°	180°	
0°	2133.	2133.	2133.	2133.	2133.	196.7
5°	1333.	1877.	2127.	2389.	2519.	449.9
15°	37.	142.	2135.	2741.	2636.	502.8
25°	31.	44.	1961.	2139.	1483.	463.8
35°	20.	29.	1668.	1194.	821.	385.5
45°	19.	23.	1477.	735.	607.	285.3
55°	18.	22.	1059.	458.	584.	230.0
65°	13.	13.	663.	412.	652.	217.1
75°	5.	9.	275.	433.	685.	178.1
85°	6.	5.	24.	353.	536.	37.1
90°	5.	5.	0.	58.	174.	340.1
95°	62.	62.	18.	6.	9.	497.8
105°	802.	711.	106.	9.	11.	509.8
115°	1642.	1159.	208.	15.	18.	446.1
125°	1672.	1188.	299.	22.	22.	327.6
135°	1521.	998.	395.	58.	26.	262.1
145°	1090.	882.	464.	173.	67.	164.9
155°	990.	822.	538.	300.	216.	55.4
165°	813.	741.	579.	428.	366.	
175°	659.	632.	585.	532.	502.	
180°	571.	571.	571.	571.	571.	

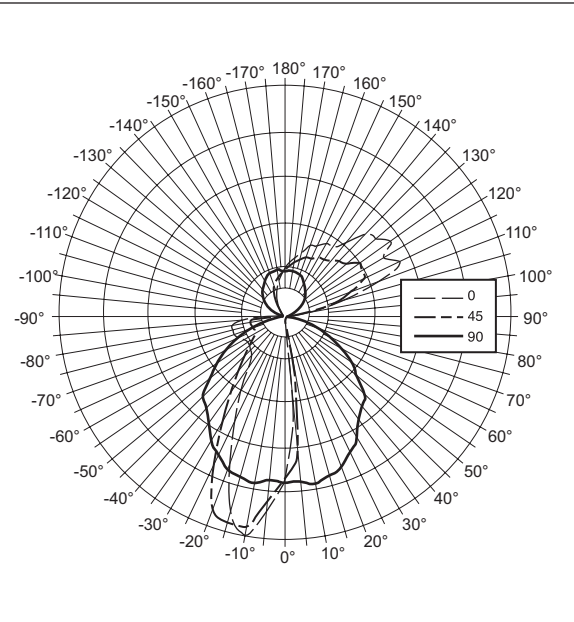

### LUMEN SUMMARY

Zone	Lumens	% Lamp	% Fixture
0 - 30	1149.	11.5	20.7
0 - 40	1613.	16.1	29.1
0 - 60	2284.	22.8	41.2
0 - 90	2909.	29.1	52.4
90 - 120	875.	8.8	15.8
90 - 130	1385.	13.8	25.0
90 - 150	2159.	21.6	38.9
90 - 180	2641.	26.4	47.6
<b>Total Luminaire:</b>			
0 - 180	5550.	55.5	100.0

Total Luminaire Optical Efficiency: **55.5%**

### ZONAL CAVITY COEFFICIENTS

	Ceiling	.80			.70			.50		
	Wall	.70	.50	.30	.70	.50	.30	.50	.30	.10
Room Cavity Ratio	0	.60	.60	.60	.55	.55	.55	.47	.47	.47
	1	.55	.52	.50	.50	.48	.46	.41	.40	.38
	2	.50	.46	.42	.46	.43	.40	.36	.34	.32
	3	.46	.41	.37	.42	.38	.35	.33	.30	.28
	4	.42	.37	.32	.39	.34	.30	.30	.27	.24
	5	.39	.33	.29	.36	.31	.27	.27	.24	.21
	6	.36	.30	.26	.34	.28	.24	.24	.21	.19
	7	.34	.27	.23	.31	.26	.22	.22	.19	.17
	8	.31	.25	.21	.29	.23	.20	.20	.17	.15
	9	.29	.23	.19	.27	.21	.18	.19	.16	.14
	10	.27	.21	.17	.25	.20	.16	.17	.14	.12

Effective Floor Cavity Reflectance = .20

### FOOTCANDLE ESTIMATOR

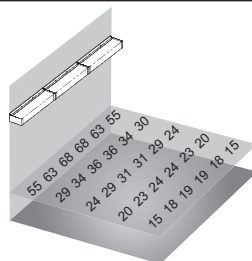

Footcandle calculations based on standard reflectance of 80/50/20 and a light loss factor of .85.

Fixture installed at 8' mounting height in 12' x 12' room with 10'-0" ceiling. Values shown are at 30" work surface height.