

SQUARE STRAIGHT STEEL POLE

SSS

SUBMITTAL:

JOB:

TYPE:

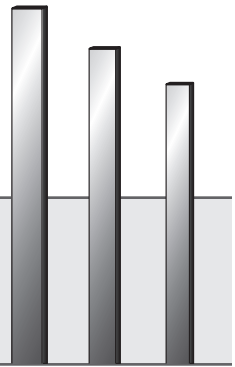

EXAMPLE: **VM - SSS - 100 - 0400 - 11 - T238 - DBR - AB - OPTIONS**

PREFIX SERIES HEIGHT SHAFT DIMENSION WALL THICKNESS FIXTURE MOUNTING FINISH OPTIONS ANCHOR BOLTS OPTIONS

SERIES

SSS — The SSS Series square straight steel pole features one-piece construction in heights up to 40'.

HEIGHT* (Must specify)

100¹	10'-0" ¹
120¹	12'-0" ¹
140¹	14'-0" ¹
160¹	16'-0" ¹
180¹	18'-0" ¹
200	20'-0"
250	25'-0"
300	30'-0"
350²	35'-0" ²
400²	40'-0" ²

¹ 11-gauge only.

² 7-gauge only.

SHAFT DIMENSION* (Must specify)

0400	4.00" (Up to 30' only)
0500	5.00" (20' to 35' only)
0600	6.00" (30' to 40' only)

WALL THICKNESS* (Must specify)

7	7-gauge (0.1793")
11	11-gauge (0.1196")

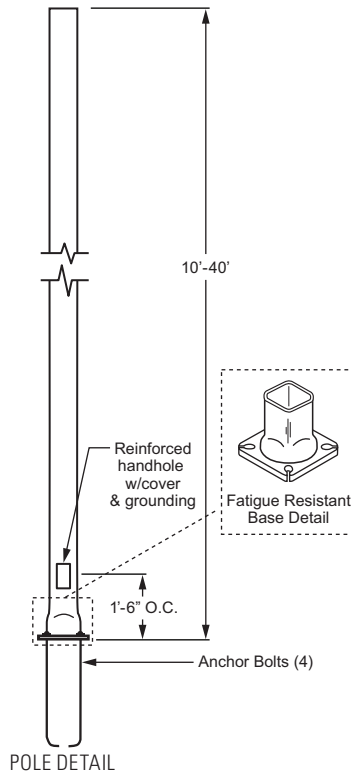

SSS SERIES

SHAFT — The pole shaft is fabricated from hot rolled commercial quality carbon steel of one-piece construction with a minimum yield strength of 55,000 psi.

POLE TOP —

A removable pole cap is provided for poles receiving drilling patterns for side-mount luminaire arm assemblies. For top mount luminaire or Williams' pole top assembly consult the factory.

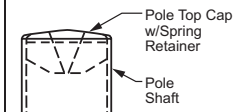

HANDHOLE —

A covered handhole and grounding provision with hardware is provided.

FULL BASE COVER —

The two-piece standard full base cover is fabricated from ABS plastic.

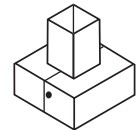

ANCHOR BASE —

The anchor base (base plate) conforms to ASTM A36.

HARDWARE —

All structural fasteners are galvanized high strength carbon steel. All non-structural fasteners are galvanized or zinc-plated carbon steel or stainless steel.

* For available Base Diameter, Wall Thickness and Height combinations, see Load and Dimensional Data Table on page 6C.

FIXTURE MOUNTING

Designed for pole top tenon or drilled side mount. See Williams' Pole Top Assemblies for various fixture mounting tenon and arm assemblies.

RADIAL INDEX — The Radial Index references how parts are oriented around the shaft. A degree measurement is used from a base point. The standard base point of reference is the handhole. Degrees are measured in a clockwise motion as viewed from the top of the shaft.

FIXTURE MOUNTING (Must specify)

POLE TOP MOUNT

T238	2-3/8" O.D. x 4" Round Tenon (Use with Williams' Pole Top Tenon Mounts)
T278	2-7/8" O.D. x 4" Round Tenon
T33	3" O.D. x 3" Round Tenon (Use with Williams' Historic Pole Top Assemblies)
T312	3-1/2" O.D. x 12" Round Tenon (Use with Williams' AVPT Decorative Pole Top Assemblies)
TC_	Custom Round Tenon (Must specify tenon diameter (O.D.) and height, consult factory)

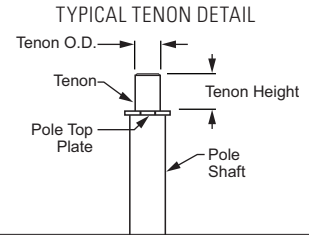

DRILLED SIDE MOUNT

Must specify drilling location using codes below. See radial index for clarification.

EXAMPLE: SM/S
(Side mount drill, single fixture located at 0°)

RADIAL INDEX

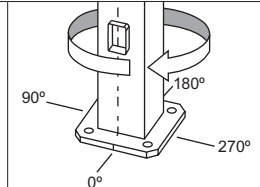
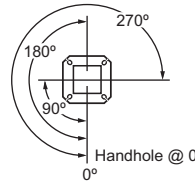

SM/S
Side Mount Drill/Single 0°
(Located at 0°)



SM/D90
Side Mount Drill/Double 90°
(Located at 0° and 90°)



SM/D180
Side Mount Drill/Double 180°
(Located at 0° and 180°)



SM/T90
Side Mount Drill/Triple 90°
(Located at 0°, 90°, and 180°)



SM/Q90
Side Mount Drill/Quad 90°
(Located at 0°, 90°, 180°, and 270°)

FINISH OPTIONS

Polyester powder coat applied over chromate pre-treatment.

FINISH OPTIONS (Must specify)

BLK	Black (RAL#9004)	DBR	Dark Bronze (Protech #PC21462)
GRAY	Standard Gray (Protech #PC18367)	GRN	Green (RAL#6005)
SLV	Satin Aluminum (RAL#9006)	WHT	White (RAL#9003)
RAL#_	Specify custom color		

ANCHOR BOLTS

Anchor bolts conform to ASTM F1554 Grade 55 and are provided with two hex nuts and two flat washers. Bolts have an "L" bend on one end and are galvanized a minimum of 12" on the threaded end. Template provided with every pole and anchor bolt order.

ANCHOR BOLTS (Must specify)

AB	Anchor bolts (4 each, shipped with pole)
LAB	Less anchor bolts
PAB	Pre-shipped Anchor Bolts (4 each)

POLE BASE SQ. (IN)	WALL THK (GA)	ANCHOR BASE				ANCHOR BOLTS			
		BOLT CIRCLE		SQ. (IN)	THK (IN)	BOLT SIZE (IN)	PROJ. (IN)	± (IN)	
		DIA (IN)	± (IN)						
4.00	11	8.50	0.50	8.25	0.750	0.75 x 17.00 x 3.00	3.50	0.25	
4.00	7	8.50	0.50	8.25	0.875	0.75 x 17.00 x 3.00	3.63	0.25	
5.00	11	11.00	1.00	11.00	1.00	0.75 x 17.00 x 3.00	3.75	0.25	
5.00	7	11.00	1.00	11.00	1.00	0.75 x 17.00 x 3.00	3.75	0.25	
6.00	7	12.00	1.00	12.50	1.00	1.00 x 36.00 x 4.00	4.25	0.25	

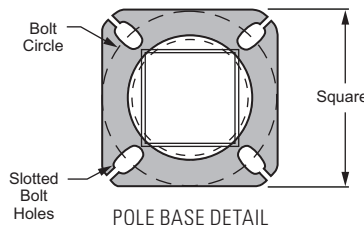

OPTIONS

FS Festoon Box only

NOTE: Casting only. Outlet, cover and hardware by others. The festoon box is located above the access door at 0°, approximately 41" above ground level.

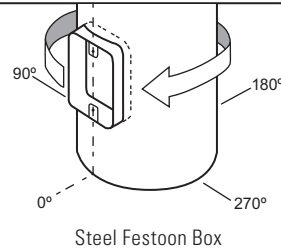

LOAD AND DIMENSIONAL DATA

HEIGHT (FT)	CATALOG NUMBER	SHAFT				80 MPH ^{3,4}		90 MPH ^{3,4}		100 MPH ^{3,4}	
		POLE BASE SQ. (IN)	POLE TOP SQ. (IN)	WALL THK. (GA)	STRUCT. WT. ⁵ (LBS)	MAX EPA (SQ FT)	MAX WEIGHT (LBS)	MAX EPA (SQ FT)	MAX WEIGHT (LBS)	MAX EPA (SQ FT)	MAX WEIGHT (LBS)
10	SSS-100-0400-11	4.00	4.00	11	75	30.6	765	23.8	595	18.9	473
12	SSS-120-0400-11	4.00	4.00	11	90	24.4	610	18.8	470	14.8	370
14	SSS-140-0400-11	4.00	4.00	11	100	19.9	498	15.1	378	11.7	293
16	SSS-160-0400-11	4.00	4.00	11	115	15.9	398	11.8	295	8.9	223
18	SSS-180-0400-11	4.00	4.00	11	125	12.6	315	9.2	230	6.7	168
20	SSS-200-0400-11	4.00	4.00	11	140	9.6	240	6.7	167	4.5	150
	SSS-200-0500-11	5.00	5.00	11	185	17.7	443	12.7	343	9.4	235
	SSS-200-0500-7	5.00	5.00	7	265	28.1	703	21.4	535	16.2	405
25	SSS-250-0400-11	4.00	4.00	11	170	4.8	150	2.6	100	1.0	50
	SSS-250-0400-7	4.00	4.00	7	245	10.8	270	7.7	188	5.4	135
	SSS-250-0500-11	5.00	5.00	11	225	9.8	245	6.3	157	3.7	150
	SSS-250-0500-7	5.00	5.00	7	360	18.5	463	13.3	333	9.5	238
30	SSS-300-0400-7	4.00	4.00	7	291	6.7	168	4.4	110	2.6	65
	SSS-300-0500-11	5.00	5.00	11	265	4.7	150	2.0	50	–	–
	SSS-300-0500-7	5.00	5.00	7	380	10.7	267	6.7	167	3.9	100
	SSS-300-0600-7	6.00	6.00	7	520	19.0	475	13.2	330	9.0	225
35	SSS-350-0500-7	5.00	5.00	7	440	5.9	150	2.5	100	–	–
	SSS-350-0600-7	6.00	6.00	7	540	12.4	310	7.6	190	4.2	105
40	SSS-400-0600-7	6.00	6.00	7	605	7.2	180	3.0	75	–	–

³ Maximum weight and Effective Projected Area (EPA) values are based on a 1.3 gust factor for side mounted fixtures only. Consult H.E. Williams, Inc. on loading criteria for pole top mounted luminaires and/or brackets. Variations from sizes above are available upon inquiry at the factory. Satisfactory performance of poles is dependent upon the pole being properly attached to a supporting foundation of adequate design. See Williams Outdoor Information Section, page 6, for Load and Dimensional Data specifics.

⁴ Wind map provided in Williams Outdoor information section, pole information page 6.

⁵ Structure weight is a nominal value which includes the pole shaft and base plate only.

- Pole installations in various parts of the country perform satisfactorily; however, in select locations destructive vibration can occur. H.E. Williams, Inc. is not responsible for vibration induced fatigue damage.
- H.E. Williams, Inc. warrants this product to be free from defects in materials and workmanship. Any defective part returned within one year from the date of delivery of the goods will be repaired or replaced without charge, F.O.B. factory. This warranty specifically excludes fatigue or similar phenomena resulting from induced vibration, harmonic oscillation or resonance associated with movement of air currents around the product. The above warranties are given in lieu of all other warranties express or implied, including without limitation, the warranty of merchantability and the warranty of suitability for a particular purpose. It is expressly stated that H.E. Williams, Inc. assumes no liability for consequential or liquidated damages arising out of a breach of the sale, including any warranties arising therefrom, and buyer's remedy shall be limited to repair or replacement of defective parts as described above. Any action for the breach under a sale including any warranties arising therefrom must be commenced within one year after the cause of action accrues.

SSS

SQUARE STRAIGHT STEEL POLE

