

ROUND STRAIGHT STEEL POLE

RSS

SUBMITTAL:

JOB:

TYPE:

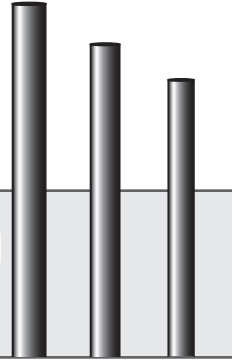

EXAMPLE:

VM - RSS - 100 - 0300 - 120 - T238 - DBR - AB - OPTIONS

PREFIX SERIES HEIGHT SHAFT DIAMETER WALL THICKNESS FIXTURE MOUNTING FINISH OPTIONS ANCHOR BOLTS OPTIONS

SERIES

RSS — The RSS Series round straight steel pole features one-piece construction in heights up to 30'.

HEIGHT* (Must specify)

100¹	10'-0"
120¹	12'-0"
140¹	14'-0"
160¹	16'-0"
180¹	18'-0"
200¹	20'-0"
250	25'-0"
300	30'-0"

¹ 0.120" wall thickness only.

SHAFT DIAMETER* (Must specify)

0300	3.00" (Up to 20' only)
0400	4.00" (Up to 25' only)
0450	4.50"
0500	5.00" (20' to 30' only)

WALL THICKNESS* (Must specify)

120	0.120" Tubing
180	0.180" Tubing (25' and 30' only)

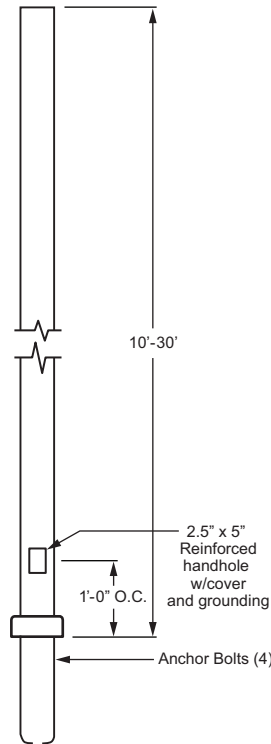

POLE DETAIL

RSS SERIES

SHAFT — The pole shaft is fabricated from hot rolled welded steel tubing of one-piece construction with a minimum yield strength of 42,000 psi.

POLE TOP — A removable pole cap is provided for poles receiving drilling patterns for side-mount luminaire arm assemblies. For top mount luminaire or Williams' pole top assembly consult the factory.

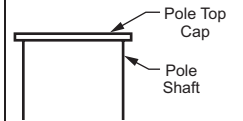

HANDHOLE — A covered handhole and grounding provision with hardware is provided.

FULL BASE COVER — The two-piece standard full base cover is fabricated from ABS plastic.

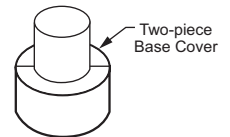

ANCHOR BASE — The anchor base (base plate) conforms to ASTM A36.

HARDWARE — All structural fasteners are galvanized high strength carbon steel. All non-structural fasteners are galvanized or zinc-plated carbon steel or stainless steel.

* For available Base Diameter, Wall Thickness and Length combinations, see Load and Dimensional Data Table on page 4C.

FIXTURE MOUNTING

Designed for pole top tenon or drilled side mount. See Williams' Pole Top Assemblies for various fixture mounting tenon and arm assemblies.

RADIAL INDEX

The Radial Index references how parts are oriented around the shaft. A degree measurement is used from a base point. The standard base point of reference is the handhole. Degrees are measured in a clockwise motion as viewed from the top of the shaft.

FIXTURE MOUNTING (Must specify)

POLE TOP MOUNT

T238	2-3/8" O.D. x 4" Round Tenon (Use with Williams' Pole Top Tenon Mounts)
T278	2-7/8" O.D. x 4" Round Tenon
T33	3" O.D. x 3" Round Tenon (Use with Williams' Historic Pole Top Assemblies)
T312	3-1/2" O.D. x 12" Round Tenon (Use with Williams' AVPT Decorative Pole Top Assemblies)
TC_	Custom Round Tenon (Must specify tenon diameter (O.D.) and height, consult factory)

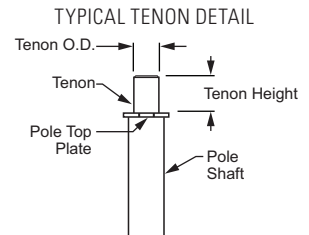

DRILLED SIDE MOUNT

Must specify drilling location using codes below. See radial index for clarification.

EXAMPLE: SM/S
(Side mount drill, single fixture located at 0°)

RADIAL INDEX

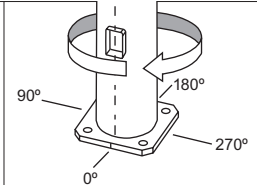
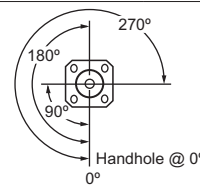

SM/S
Side Mount Drill/Single 0°
(Located at 0°)



SM/D90
Side Mount Drill/Double 90°
(Located at 0° and 90°)



SM/D180
Side Mount Drill/Double 180°
(Located at 0° and 180°)



SM/T90
Side Mount Drill/Triple 90°
(Located at 0°, 90°, and 180°)



SM/T120
Side Mount Drill/Triple 120°
(Located at 0°, 120°, and 240°)



SM/Q90
Side Mount Drill/Quad 90°
(Located at 0°, 90°, 180°, and 270°)

FINISH OPTIONS

Polyester powder coat applied over chromate pre-treatment.

FINISH OPTIONS (Must specify)

BLK	Black (RAL#9004)	DBR	Dark Bronze (Protech #PC21462)
GRAY	Standard Gray (Protech #PC18367)	GRN	Green (RAL#6005)
SLV	Satin Aluminum (RAL#9006)	WHT	White (RAL#9003)
RAL#	Specify custom color		

ANCHOR BOLTS

Anchor bolts conform to ASTM F1554 Grade 55 and are provided with two hex nuts and two flat washers. Bolts have an "L" bend on one end and are galvanized a minimum of 12" on the threaded end. Template provided with every pole and anchor bolt order.

ANCHOR BOLTS (Must specify)

AB	Anchor bolts (4 each, shipped with pole)
LAB	Less anchor bolts
PAB	Pre-shipped Anchor Bolts (4 each)

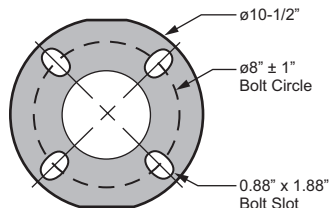

ANCHOR BASE DETAIL

BASE O.D. (IN)	WALL THK (IN)	POLE		ANCHOR BASE		ANCHOR BOLTS		
		DIA (IN)	± (IN)	DIA (IN)	THK (IN)	BOLT SIZE (IN)	PROJ. (IN)	± (IN)
3.00	0.120	8.00	1.00	10.50	0.75	0.75 x 17.00 x 3.00	3.50	0.25
4.00	0.120	8.00	1.00	10.50	0.75	0.75 x 17.00 x 3.00	3.50	0.25
4.50	0.120	8.00	1.00	10.50	0.75	0.75 x 17.00 x 3.00	3.50	0.25
5.00	0.120	8.00	1.00	10.50	0.75	0.75 x 17.00 x 3.00	3.50	0.25
5.00	0.180	8.00	1.00	10.50	0.75	0.75 x 17.00 x 3.00	3.50	0.25

OPTIONS

FS Festoon Box only

NOTE: Casting only. Outlet, cover and hardware by others. The festoon box is located above the access door at 0°, approximately 41" above ground level.

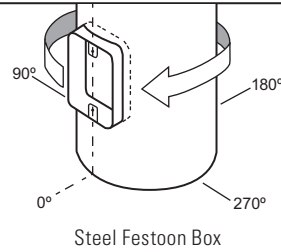

LOAD AND DIMENSIONAL DATA

HEIGHT (FT)	CATALOG NUMBER	POLE DIMENSIONS				80 MPH ^{2,3}		90 MPH ^{2,3}		100 MPH ^{2,3}	
		BASE O.D. (IN)	TOP O.D. (IN)	WALL THK (IN)	STRUCT. WT. ⁴ (LBS)	MAX EPA (SQ FT)	MAX WEIGHT (LBS)	MAX EPA (SQ FT)	MAX WEIGHT (LBS)	MAX EPA (SQ FT)	MAX WEIGHT (LBS)
10	RSS-100-0300-120	3.00	3.00	0.120	55	10.00	250	7.70	190	6.00	175
	RSS-100-0400-120	4.00	4.00	0.120	70	19.10	480	15.00	375	12.20	305
	RSS-100-0450-120	4.50	4.50	0.120	75	24.50	615	19.50	490	15.80	395
12	RSS-120-0300-120	3.00	3.00	0.120	60	7.70	195	5.80	145	4.40	130
	RSS-120-0400-120	4.00	4.00	0.120	80	15.00	390	11.80	300	9.50	240
	RSS-120-0450-120	4.50	4.50	0.120	85	19.80	495	15.70	395	12.70	320
14	RSS-140-0300-120	3.00	3.00	0.120	70	6.00	175	4.40	130	3.30	90
	RSS-140-0400-120	4.00	4.00	0.120	90	12.20	305	9.40	250	7.60	195
	RSS-140-0450-120	4.50	4.50	0.120	95	16.20	405	12.80	320	10.30	260
16	RSS-160-0300-120	3.00	3.00	0.120	80	4.60	125	3.20	100	2.30	60
	RSS-160-0400-120	4.00	4.00	0.120	100	9.60	250	7.40	185	5.90	150
	RSS-160-0450-120	4.50	4.50	0.120	105	13.10	330	10.20	265	8.20	205
18	RSS-180-0300-120	3.00	3.00	0.120	90	3.40	90	2.30	60	1.40	70
	RSS-180-0400-120	4.00	4.00	0.120	110	7.60	190	5.70	180	4.50	130
	RSS-180-0450-120	4.50	4.50	0.120	115	10.50	265	8.20	210	6.50	165
20	RSS-200-0300-120	3.00	3.00	0.120	100	2.40	100	1.40	75	-	-
	RSS-200-0400-120	4.00	4.00	0.120	120	6.00	150	4.45	150	3.45	125
	RSS-200-0450-120	4.50	4.50	0.120	130	8.50	215	6.60	165	5.20	130
	RSS-200-0500-120	5.00	5.00	0.120	145	11.75	300	9.10	230	7.25	180
25	RSS-250-0400-120	4.00	4.00	0.120	145	2.85	100	1.95	75	1.35	75
	RSS-250-0450-120	4.50	4.50	0.120	155	4.80	130	3.60	90	2.70	90
	RSS-250-0500-120	5.00	5.00	0.120	180	7.25	180	5.50	150	4.25	150
	RSS-250-0500-180	5.00	5.00	0.180	260	12.10	300	9.40	250	7.45	200
30	RSS-300-0450-120	4.50	4.50	0.120	185	2.30	80	1.50	75	1.00	60
	RSS-300-0500-120	5.00	5.00	0.120	210	4.20	150	3.00	125	2.25	100
	RSS-300-0500-180	5.00	5.00	0.180	305	8.00	200	6.50	160	4.75	125

² Maximum weight and Effective Projected Area (EPA) values are based on a 1.3 gust factor for side mounted fixtures only. Consult H.E. Williams, Inc. on loading criteria for pole top mounted luminaires or arm assemblies. Variations from sizes above are available upon inquiry. Satisfactory performance of poles is dependent upon the pole being properly attached to a supporting foundation of adequate design. See Williams Outdoor Information Section, page 6, for Load and Dimensional Data specifics.

³ Wind map provided in Williams Outdoor Information Section, page 6.

⁴ Structure weight is a nominal value which includes the pole shaft and base plate only.

• Pole installations in various parts of the country perform satisfactorily; however, in select locations destructive vibration can occur. H.E. Williams, Inc. is not responsible for vibration induced fatigue damage.

• H.E. Williams, Inc. warrants this product to be free from defects in materials and workmanship. Any defective part returned within one year from the date of delivery of the goods will be repaired or replaced without charge, F.O.B. factory.

This warranty specifically excludes fatigue or similar phenomena resulting from induced vibration, harmonic oscillation or resonance associated with movement of air currents around the product.

The above warranties are given in lieu of all other warranties express or implied, including without limitation, the warranty of merchantability and the warranty of suitability for a particular purpose. It is expressly stated that H.E. Williams, Inc. assumes no liability for consequential or liquidated damages arising out of a breach of the sale, including any warranties arising therefrom, and buyer's remedy shall be limited to repair or replacement of defective parts as described above.

Any action for the breach under a sale including any warranties arising therefrom must be commenced within one year after the cause of action accrues.

RSS

ROUND STRAIGHT STEEL POLE

