

SQUARE STRAIGHT ALUMINUM POLE

SSA

SUBMITTAL:

JOB:

TYPE:

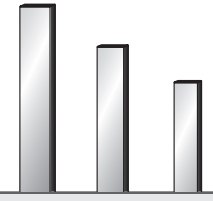

EXAMPLE: VM - SSA - 080 - 0400 - 125 - T238 - DBR - AB - OPTIONS

PREFIX SERIES HEIGHT SHAFT DIMENSION WALL THICKNESS FIXTURE MOUNTING FINISH OPTIONS ANCHOR BOLTS OPTIONS

SERIES

SSA — The SSA Series square straight aluminum pole features one-piece construction in heights up to 35'.

HEIGHT* (Must specify)

080 ¹	8'-0" ¹
100 ¹	10'-0" ¹
120 ¹	12'-0" ¹
140 ¹	14'-0" ¹
150 ¹	15'-0" ¹
160	16'-0"
180	18'-0"
200	20'-0"
250	25'-0"
300 ²	30'-0" ²
320 ²	32'-0" ²
350 ²	35'-0" ²

¹ 0.125" Wall Thickness only.
² 0.250" Wall Thickness only.

SHAFT DIMENSION* (Must specify)

0400	4.00" (Up to 20' only)
0500	5.00" (18' - 25' only)
0600	6.00" (20' - 35' only)
0675	6.75" (30' - 35' only)

WALL THICKNESS* (Must specify)

125	0.125" (Up to 20' only)
188	0.188" (16' - 25' only)
250	0.250" (20' - 35' only)

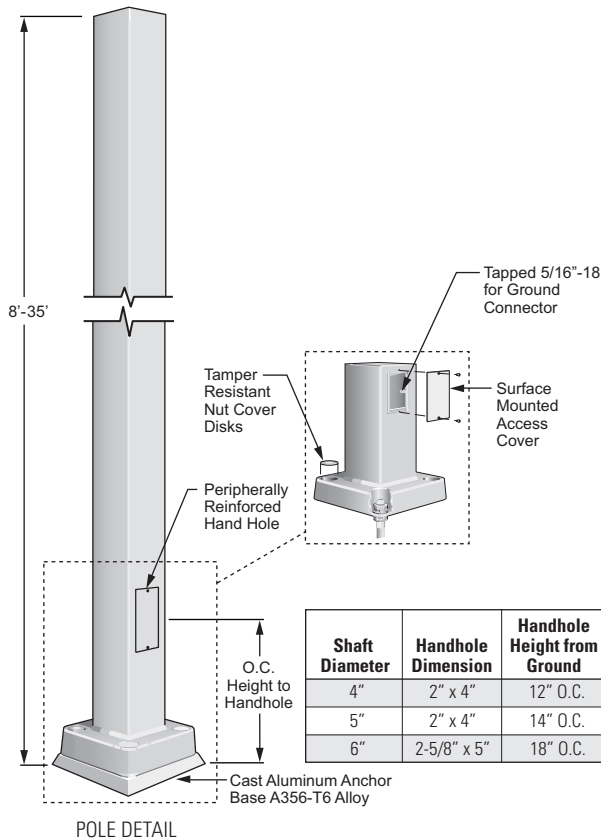

SSA SERIES

SHAFT — The shaft is extruded from all new seamless 6000 series alloy aluminum tubing. Square shafts are supplied with a pole top cap when the shafts are drilled for side mounting of luminaires. Square straight shafts with a satin finish are longitudinally polished, resulting in a high-quality brushed finish. After finishing, each pole is fully wrapped for protection in shipment.

HANDHOLE — All straight square aluminum poles include a wire access opening with a surface-mounted cover.

ANCHOR BASE — The anchor base is cast from A356 alloy aluminum and is circumferentially welded to the shaft. The completed assembly will be heat treated to a T6 temper after all structural welding is completed. The anchor bolt recesses in the anchor base casting are flush and covered by four temper resistant aluminum nut cover disks.

GROUND LUG PROVISION — Each pole includes a 5/16"-18 tapped provision for ground connector located opposite the handhole.

* For available Base Diameter, Wall Thickness and Height combinations, see Load and Dimensional Data Table on page 3C.

FIXTURE MOUNTING

Luminaires may be mounted on tenons or shaft may be drilled to specifications. When poles are drilled for luminaire mounting, black plastic pole top caps will be supplied. See Williams' Pole Top Assemblies for various fixture mounting tenon and arm assemblies.

RADIAL INDEX

The Radial Index references how parts are oriented around the shaft. A degree measurement is used from a base point. The standard base point of reference is the handhole. Degrees are measured in a clockwise motion as viewed from the top of the shaft.

FIXTURE MOUNTING (Must specify)

POLE TOP MOUNT

T238	2-3/8" O.D. x 4" Round Tenon (Use with Williams' Pole Top Tenon Mounts)
T278	2-7/8" O.D. x 4" Round Tenon
T33	3" O.D. x 3" Round Tenon (Use with Williams' Historic Pole Top Assemblies)
T312	3-1/2" O.D. x 12" Round Tenon (Use with Williams' AVPT Decorative Pole Top Assemblies)
TC_____	Custom Round Tenon (Must specify tenon diameter (O.D.) and height, consult factory)

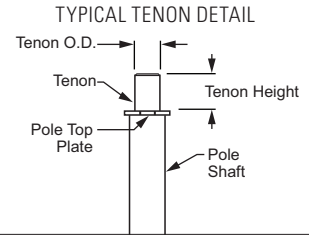

DRILLED SIDE MOUNT

Must specify drilling location using codes below. See radial index for clarification.

EXAMPLE: SM/S
(Side mount drill, single fixture located at 0°)

RADIAL INDEX

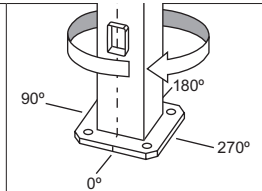
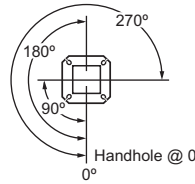

SM/S

Side Mount Drill/Single 0°
(Located at 0°)



SM/D90

Side Mount Drill/Double 90°
(Located at 0° and 90°)



SM/D180

Side Mount Drill/Double 180°
(Located at 0° and 180°)



SM/T90

Side Mount Drill/Triple 90°
(Located at 0°, 90°, and 180°)



SM/Q90

Side Mount Drill/Quad 90°
(Located at 0°, 90°, 180°, and 270°)

FINISH OPTIONS

Polyester powder coat applied over chromate pre-treatment.

FINISH OPTIONS (Must specify)

BLK	Black (RAL#9004)	DBR	Dark Bronze (Protech #PC21462)
GRAY	Standard Gray (Protech #PC18367)	GRN	Green (RAL#6005)
SLV	Satin Aluminum (RAL#9006)	WHT	White (RAL#9003)
RAL#_____	Specify custom color		

ANCHOR BOLTS (Must specify)

AB	Anchor bolts (4 each, shipped with pole)
LAB	Less anchor bolts
PAB	Pre-shipped Anchor Bolts (4 each)

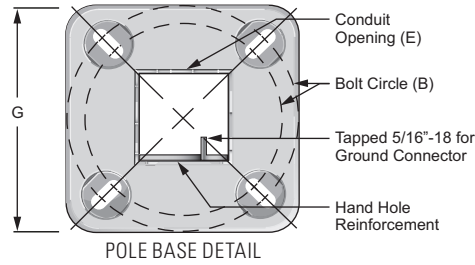
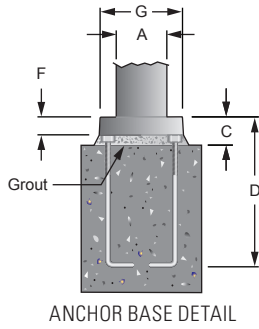

ANCHOR BOLTS

Each pole includes four steel hot dip galvanized anchor bolts each with two nuts and two flat washers sized to match the anchor bolts. Template provided with every pole and anchor bolt order.

SQ. SIZE (A)	BOLT CIRCLE (B)	BOLT PROJECT. (C)	BOLT SIZE (D)	CONDUIT OPENING (E)	BASE HT. (F)	BASE SIZE (G)
4"	8.5" - 9.5"	3.125" ± 0.125"	.75 x 17"	3.5"	2"	9.9375"
5"	10.75" - 11.50"	3.25" ± 0.125"	.75 x 17"	4.5"	2.5"	11.5625"
6"	12" - 13"	4.00" ± 0.125"	1" x 36"	5.5"	2.75"	12.75"
6.75"	14.125" - 15.125"	4.25" ± 0.125"	1" x 36"	6.25"	3.625"	15.125"

OPTIONS

FS Festoon Box only

NOTE: Casting only. Outlet, cover and hardware by others. The festoon box is located above the access door at 0°, approximately 41" above ground level.

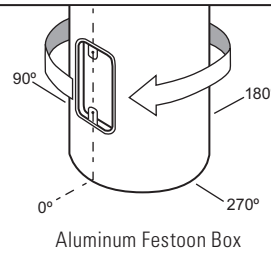

- VB1** Vibration Damper (Factory installed)
- VB2** Vibration Damper (Field Installed, 10'-20')
- VB3** Vibration Damper (Field Installed 22'-30')
- VB4** Vibration Damper (Field Installed 32'-40')

LOAD AND DIMENSIONAL DATA

HEIGHT (FT)	CATALOG NUMBER	SHAFT		MAXIMUM LUMINAIRE WT. (LBS)	MAX EPA (SQ FT) ^{3,4}				
		OUTSIDE SQUARE (IN)	WALL THK. (IN)		70 MPH	80 MPH	90 MPH	100 MPH	110 MPH
8	SSA-080-0400-125	4.00	.125	350	26.6	19.9	15.2	11.9	9.5
10	SSA-100-0400-125	4.00	.125	260	20.6	15.2	11.4	8.8	6.8
12	SSA-120-0400-125	4.00	.125	260	16.0	11.5	8.5	6.3	4.6
14	SSA-140-0400-125	4.00	.125	200	12.9	9.0	6.4	4.5	3.1
15	SSA-150-0400-125	4.00	.125	200	9.1	6.2	4.2	2.8	1.8
16	SSA-160-0400-125	4.00	.125	200	7.9	5.3	3.4	2.1	1.1
	SSA-160-0400-188	4.00	.188	200	13.3	9.4	6.7	4.7	3.3
18	SSA-180-0400-125	4.00	.125	100	6.4	4.0	2.3	1.1	-
	SSA-180-0400-188	4.00	.188	150	11.0	7.4	5.0	3.3	2.0
	SSA-180-0500-188	5.00	.188	260	19.2	13.5	9.6	6.8	4.7
20	SSA-200-0400-125	4.00	.125	150	4.5	2.3	-	-	-
	SSA-200-0400-188	4.00	.188	150	8.8	5.6	3.5	1.9	-
	SSA-200-0500-188	5.00	.188	150	16.4	11.2	7.6	5.0	3.2
	SSA-200-0600-188	6.00	.188	150	26.1	18.3	13.0	9.2	6.4
	SSA-200-0600-250	6.00	.250	260	35.4	25.4	18.6	13.7	10.1
25	SSA-250-0500-188	5.00	.188	100	10.2	6.0	3.2	1.1	-
	SSA-250-0600-188	6.00	.188	260	16.6	10.6	6.5	3.5	1.3
	SSA-250-0600-250	6.00	.250	260	24.4	16.5	11.2	7.3	4.5
30	SSA-300-0600-250	6.00	.250	260	14.8	9.0	5.0	2.1	-
	SSA-300-0675-250	6.75	.250	260	21.1	13.5	8.2	4.5	1.7
32	SSA-320-0600-250 ⁵	6.00	.250	150	12.7	7.1	3.3	-	-
35	SSA-350-0600-250 ⁵	6.00	.250	100	9.4	4.3	-	-	-
	SSA-350-0675-250 ⁵	6.75	.250	150	14.1	7.6	3.1	-	-

³ Effective Projected Area (EPA) calculations are based on a 1.3 Gust Factor. Variations from sizes listed above available upon inquiry. Satisfactory performance of lighting poles is dependent upon the pole being properly attached to a supporting foundation of adequate design. H.E. Williams, Inc. does not offer recommendations for foundations. See Williams Outdoor Information Section, page 6, for Load and Dimensional Data specifics.

⁴ Wind map provided in Williams Outdoor information section, pole information page 6.

⁵ Pole includes factory installed vibration damper.

- Pole installations in various parts of the country perform satisfactorily; however, in select locations destructive vibration can occur. H.E. Williams, Inc. is not responsible for vibration induced fatigue damage.

- H.E. Williams, Inc. warrants this product to be free from defects in materials and workmanship. Any defective part returned within one year from the date of delivery of the goods will be repaired or replaced without charge, F.O.B. factory.

This warranty specifically excludes fatigue or similar phenomena resulting from induced vibration, harmonic oscillation or resonance associated with movement of air currents around the product.

The above warranties are given in lieu of all other warranties express or implied, including without limitation, the warranty of merchantability and the warranty of suitability for a particular purpose. It is expressly stated that H.E. Williams, Inc. assumes no liability for consequential or liquidated damages arising out of a breach of the sale, including any warranties arising therefrom, and buyer's remedy shall be limited to repair or replacement of defective parts as described above.

Any action for the breach under a sale including any warranties arising therefrom must be commenced within one year after the cause of action accrues.