

4.5" ROUND LED DOWNLIGHT – HIGH LUMEN

LEDS45H

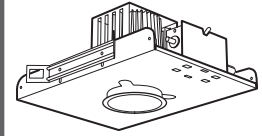

SUBMITTAL:

JOB:

TYPE:

VOLTAGE:

EXAMPLE

LEDS45H - 1100 - 35K - CS - OPTIONS - ED*OS - 120

SERIES

LUMEN PACKAGE

MODULE COLOR TEMPERATURE

REFLECTOR FINISH

OPTIONS

DRIVER

VOLTAGE

FEATURES

- ▶ LEDs deliver an exemplary combination of light output, high-efficacy, and pleasing color.
- ▶ Rated for 50,000 hours at 70% lumen maintenance (L70).
- ▶ Nominal 83 CRI (color rendering index).
- ▶ 3500K color temperature.
- ▶ System-integrated emergency LED driver available.
- ▶ Module-integrated heat sink dissipates heat.
- ▶ Delivers quality illumination in a small 4.5" aperture.
- ▶ Integral pan throat field-adjusts to accommodate ceilings up to 1-5/8" thick.
- ▶ Self-flanged aluminum reflector offers maximum lamp performance and provides crisp, clean installation without unsightly light leaks.
- ▶ Adjustable hanger brackets with bar hangers standard.
- ▶ Sturdy one-piece pan construction with yoke mount.
- ▶ Easy-access 14-gauge galvanized steel junction box with two snap-on covers.
- ▶ This fixture is proudly made in the USA.

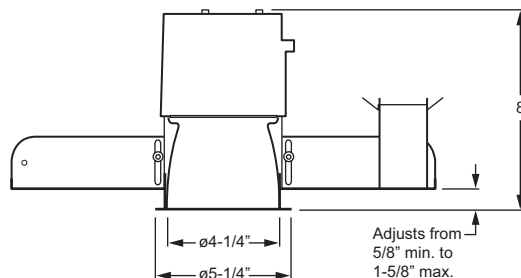

Pan Size: 12" x 16-1/4"
Ceiling Cutout: 4-3/4"

Note: Access from above the fixture is required for maintenance of LED module.

SPECIFICATIONS

Housing – 20-gauge die-formed galvanized steel pan/plaster frame with adjustable throat (5/8" to 1-5/8").

Reflector – Low-iridescent aluminum. Clear semi-specular (CS) finish standard.

LED Module & Driver – 18-watt, 1100-lumen, 3500K, Osram Sylvania DLM LED module with Osram OPTOTRONIC® constant current, Class 2 power supply. Integral cast aluminum heat sink.

Electrical – Prewired at factory for easy field installation. Integral thermal protector.

Mounting – Recessed. **Labels** – cETLus conforms to UL STD 1598; Certified to CAN/CSA STD C22.2 No. 250.0. Suitable for damp locations.

Qualifications – RoHS compliant.

Warranty – 5-Year Parts Warranty provided by Osram Sylvania on LED module and driver.

ORDERING INFORMATION

SERIES

LEDS45H 4.5" Round LED Downlight–High Lumen

LUMEN PACKAGE

1100 18-watt, 1100-lumen, Osram Sylvania DLM1100 LED module

LED MODULE COLOR TEMPERATURE

35K 3500K

REFLECTOR FINISH (Must specify)

CS Clear semi-specular (standard)
CG Champagne gold
GD Gold
PW Pewter
SG Satin-glow
SPC Clear specular
STR Straw
WT Wheat

OPTIONS

MWT Matte white trim
EM/I-2412EMA/1 Emergency LED driver

DRIVER (Must specify)

ED*OS	Osram Sylvania LED driver
EDD*LU*HILUME L3D ECO	Lutron Hi-lume® LED dimming driver for Eco-System® controls
EDD*LU*HILUME L3D 3WIRE	Lutron Hi-lume® LED dimming driver for 3-wire controls
EDD*LU*HILUME LTE LINE	Lutron Hi-lume® LED dimming driver for forward phase line voltage controls (120V only)

VOLTAGE (Must specify)

120 120V
277 277V (not available with EDD*LU*HILUME LTE LINE)



The U.S. Department of Energy's Lighting Facts® Program has verified product performance based on industry-standardized testing. For details, see H.E. Williams LEDS45H at www.lightingfacts.com/products.

PHOTOMETRY INFORMATION

Catalog #: LEDS45H-1100-35K-SPC

TEST REPORT INFORMATION

- ▶ Test Report #: 14935.0
- ▶ Date: 09/23/09
- ▶ Lamp Type: LED
- ▶ Lamp Quantity: 1
- ▶ **Rated Lumens: 731**
- ▶ **Watts: 21.6**
- ▶ **Lumens Per Watt: 33**
- ▶ **CRI: 82**
- ▶ **CCT: 3439K**

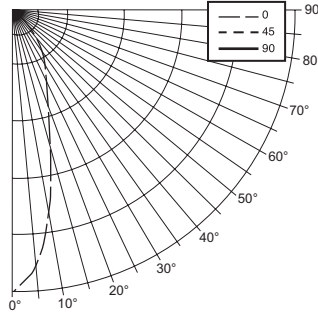

CANDLEPOWER DISTRIBUTION

Vertical Angle	Horizontal Angle 0°	Zonal Lumens
0°	1435.	
5°	1318.	125.8
15°	718.	203.5
25°	398.	184.3
35°	231.	145.0
45°	91.	70.6
55°	2.	1.8
65°	0.	0.0
75°	0.	0.0
85°	0.	0.0
90°	0.	0.0

ZONAL CAVITY COEFFICIENTS

	Ceiling	.80			.70			.50		
	Wall	.70	.50	.30	.70	.50	.30	.50	.30	.10
Room Cavity Ratio	0	1.19	1.19	1.19	1.16	1.16	1.16	1.11	1.11	1.11
	1	1.14	1.11	1.09	1.11	1.09	1.07	1.05	1.03	1.02
	2	1.08	1.04	1.00	1.06	1.02	.98	.99	.96	.93
	3	1.03	.97	.92	1.01	.95	.91	.93	.89	.86
	4	.98	.91	.85	.96	.89	.84	.87	.83	.80
	5	.93	.85	.79	.92	.84	.79	.82	.78	.74
	6	.89	.80	.74	.87	.79	.74	.78	.73	.69
	7	.85	.76	.70	.83	.75	.69	.74	.69	.65
	8	.81	.71	.66	.79	.71	.65	.70	.65	.61
	9	.77	.68	.62	.76	.67	.62	.66	.61	.58
	10	.74	.64	.59	.73	.64	.59	.63	.58	.55

Effective Floor Cavity Reflectance = .20

LIGHT CONE QUICK CALCULATOR TABLES

	Mounting Height (Ft)	FC at Edge of Cone	FC at Nadir	Cone Dia. (Feet)	
				Across	Diagonal
Room Cavity Ratio	8	11.2	22.4	4.0	3.2
	10	7.2	14.4	5.0	4.0
	12	5.0	10.0	6.0	4.8
	14	3.7	7.3	7.0	5.6
	16	2.8	5.6	8.0	6.4
	18	2.2	4.4	9.0	7.2
	20	1.8	3.6	10.0	8.0

Effective Floor Cavity Reflectance = .20

LUMEN SUMMARY

Zone	Lumens	% Fixture
0 - 30	514.	70.3
0 - 40	659.	90.1
0 - 60	731.	100.0
0 - 90	731.	100.0
Total Luminaire:		
0 - 180	731.	100.0

IES Spacing Criteria: Diagonal = 0.4
Across = 0.5

LUMINANCE DATA (cd/m²)

Vertical Angle	Horizontal Angle 0°
45	12463.
55	337.
65	0.
75	0.
90	0.

CANDLEPOWER MULTIPLIER

Catalog Number	Reflector Finish	Conversion Factor
SPC	Specular	1.02
CG	Champagne gold	.96
GD	Gold	.93
PW	Pewter	.86
STR	Straw	.97
WT	Wheat	.88

