

# DECORATIVE CAGED GLOBE LUMINAIRE

# OGC

**SUBMITTAL:**

**JOB:**

**TYPE:**

**VOLTAGE:**

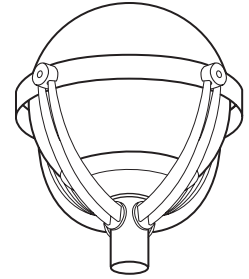

**EXAMPLE:** OGC 18 - 150PSMH120 - ACR - WHT - T5GR - DBR

SERIES    GLOBE SIZE    ELECTRICAL PACKAGE    GLOBE MATERIAL    GLOBE COLOR    PHOTO. DIST.    FINISH OPTIONS

## SERIES

### FEATURES

- ▶ Structural cage features decorative medallions and architectural band.
- ▶ Choice of impact-resistant polycarbonate or U.V. stabilized acrylic diffuser.
- ▶ Choice of clear or white globe.
- ▶ Glass refractor, stack reflector, or bare lamp options for varied distribution.
- ▶ HID lamping up to 150 watts.

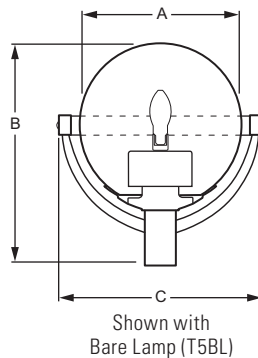

**WET LOCATION** **USA PROUD**  
This fixture is proudly made in the USA.

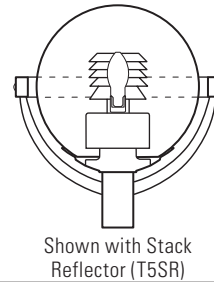
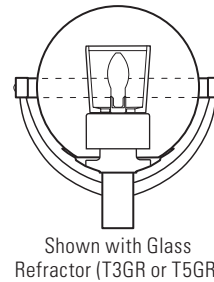

## GLOBE SIZE (Must specify)

GLOBE SIZE	A	B	C	EPA	WEIGHT
16	ø16"	21-7/8"	20-3/8"	1.33	27 Lbs.
18	ø18"	23-7/16"	22-3/8"	1.62	28 Lbs.
20	ø20"	25-9/16"	24-3/8"	1.94	28 Lbs.

## ELECTRICAL PACKAGE (Must specify)

### PULSE START METAL HALIDE

Lamp:	ED-17/E17	ED-17/E17	ED-17/E17	ED-17/E17
Socket:	E26 Medium	E26 Medium	E26 Medium	E26 Medium
ANSI Ballast Code:	M110/M148	M98/M143	M90/M140	M102/M142
	50PSMH120	70PSMH120	100PSMH120	150PSMH120
	50PSMH208	70PSMH208	100PSMH208	150PSMH208
	50PSMH240	70PSMH240	100PSMH240	150PSMH240
	50PSMH277	70PSMH277	100PSMH277	150PSMH277
		70PSMH347	100PSMH347	150PSMH347
			100PSMH480	150PSMH480

### HIGH PRESSURE SODIUM

Lamp:	E17	E17	E17	E17
Socket:	E26 Medium	E26 Medium	E26 Medium	E26 Medium
ANSI Ballast Code:	S68	S62	S54	S55
	50HPS120	70HPS120	100HPS120	150HPS120
	50HPS208	70HPS208	100HPS208	150HPS208
	50HPS240	70HPS240	100HPS240	150HPS240
	50HPS277	70HPS277	100HPS277	150HPS277
		70HPS347	100HPS347	150HPS347
			100HPS480	150HPS480

## OGC SERIES

Available in 16", 18", or 20" globe sizes.

### FIXTURE BASE —

Cast aluminum base with spun aluminum cover.

### ENCLOSURE —

Impact-resistant polycarbonate or U.V. stabilized acrylic globe. Gasketed for weathertight performance.

**CAGE** — Welded aluminum construction with decorative medallions and cast aluminum slip fitter.

## ELECTRICAL PACKAGE

**PSMH** — Rated -20°F minimum starting temperature.

**HPS** — Rated -40°F minimum starting temperature.

All PSMH and HPS electrical packages include porcelain socket and integral ballast. Prewired at factory to a disconnect plug for easy field installation. HX-HPF or CWA ballast type standard. Lamp is optional, please specify when ordering.

## GLOBE MATERIAL

Impact-resistant polycarbonate or U.V. stabilized acrylic.

### GLOBE MATERIAL (Must specify)

- ACR** Acrylic
- CPC** Polycarbonate

## GLOBE COLOR

Available in clear or white.

### GLOBE COLOR (Must specify)

- CLR** Clear
- WHT** White

## DISTRIBUTION

### BARE LAMP

Bare lamp option in Type V distribution.

### REFRACTOR

Glass refractor in Type III or Type V distribution.

### STACK REFLECTOR

Spun aluminum stack reflector with a specular finish in Type V distribution.

### PHOTOMETRIC DISTRIBUTION (Must specify)

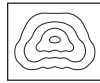

**T3GR** Type III glass refractor (Clear globe only)



**T5BL** Type V bare lamp  
**T5GR** Type V glass refractor  
**T5SR** Type V stack reflector

## FINISH OPTIONS

Super durable polyester powder coat meets and exceeds AAMA 2604 specifications for outdoor durability.

### FINISH OPTIONS (Must specify)

- BLK** Black (RAL# 9004)
- DBR** Dark bronze (Protech #PC21462)
- GRAY** Standard gray (Protech #PC18367)
- GRN** Green (RAL# 6005)
- SLV** Satin aluminum (RAL# 9006)
- WHT** White (RAL# 9003)
- RAL#** \_\_\_\_\_ Specify custom color

## MOUNTING POINT

Post top mounting on 2-3/8" O.D. tenon or pole top. Secured with stainless steel set screws. See Williams' Poles or Pole Top Assemblies for details.

## LABELS

cCSAus certified as luminaire suitable for wet location.