

24" ROUND YOKE MOUNT AREA LIGHT WITH VERTICAL LAMP

OBSV24

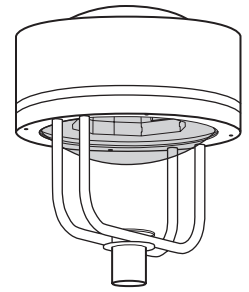

SUBMITTAL:

JOB:

TYPE:

VOLTAGE:

EXAMPLE: **OBSV24** - **400PSMH120** - **T3** - **DBR** - **OPTIONS**

SERIES

ELECTRICAL PACKAGE

DIST.

FINISH OPTIONS

OPTIONS



This fixture is proudly made in the USA.

SERIES

- ▶ Yoke mount design for pole top mounting.
- ▶ Spring latches lock hinged fixture housing into place for easy relamping.
- ▶ Architecturally designed with a horizontal reveal.
- ▶ HID lamping up to 400 watts.
- ▶ 90° rotatable reflector allows orientation to be easily altered on-site.
- ▶ Highly specular, multi-faceted aluminum reflector.

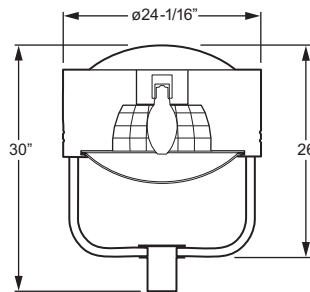

EPA: 2.11/Weight: 47 Lbs.

OBSV24 SERIES

HOUSING — One-piece spun aluminum housing, .100" wall thickness, with internal reinforcement and component bracketing.

DOOR — Cast aluminum hinged door fastened using stainless steel hardware.

LENS — Clear, .187" thick high-impact, heat-resistant tempered glass drop lens, secured with retaining clips, sealed with silicone.

ELECTRICAL PACKAGE (Must specify)

PULSE START METAL HALIDE

Lamp:	E17	BT28	BT28	BT37
Socket:	E26 Medium	E39 Mogul	E39 Mogul	E39 Mogul
ANSI Ballast Code:	M102	M153	M154	M155
	150PSMH120	250PSMH120	320PSMH120	400PSMH120
	150PSMH208	250PSMH208	320PSMH208	400PSMH208
	150PSMH240	250PSMH240	320PSMH240	400PSMH240
	150PSMH277	250PSMH277	320PSMH277	400PSMH277
	150PSMH347	250PSMH347	320PSMH347	400PSMH347
	150PSMH480	250PSMH480	320PSMH480	400PSMH480

HIGH PRESSURE SODIUM

Lamp:	E17	ET18	ET18
Socket:	E26 Medium	E39 Mogul	E39 Mogul
ANSI Ballast Code:	S55	S50	S51
	150HPS120	250HPS120	400HPS120
	150HPS208	250HPS208	400HPS208
	150HPS240	250HPS240	400HPS240
	150HPS277	250HPS277	400HPS277
	150HPS347	250HPS347	400HPS347
	150HPS480	250HPS480	400HPS480

ELECTRICAL PACKAGE

PSMH — Rated -20°F minimum starting temperature.

HPS — Rated -40°F minimum starting temperature.

All PSMH and HPS electrical packages include porcelain socket. Core and coil ballast mounted on removable ballast tray. Prewired at factory to a disconnect plug for easy field installation. HX-HPF or CWA ballast type standard. Lamp is optional, please specify when ordering.



OBSV24

24" ROUND YOKE MOUNT AREA LIGHT WITH VERTICAL LAMP

REFLECTOR

Precisely formed highly specular, multi-faceted aluminum reflector secured with thumb screws. The reflector can be rotated in 90° increments allowing orientation to be altered on-site.

DISTRIBUTION (Must specify)



T2
Type II



T3
Type III



T5
Type V

FINISH OPTIONS

Super durable polyester powder coat meets and exceeds AAMA 2604 specifications for outdoor durability.

FINISH OPTIONS (Must specify)

BLK	Black (RAL #9004)
DBR	Dark bronze (Protech #PC21462)
GRAY	Standard gray (Protech #PC18367)
GRN	Green (RAL #6005)
SLV	Satin aluminum (RAL #9006)
WHT	White (RAL #9003)
RAL# _____	Specify custom color

MOUNTING

Yoke mount consists of two parallel 1" O.D. aluminum tubes formed and welded to a cast aluminum door and slip fitter. Fits 3" O.D. x 3" tenon or pole top.

OPTIONS

SF	Single fuse (120V, 277V, or 347V only; must specify voltage)	DF	Double fuse (208V, 240V, or 480V only; must specify voltage)
-----------	--	-----------	--

RELAMPING FEATURE

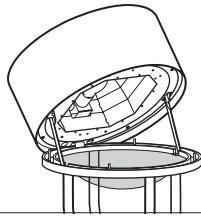

Spring latches lock hinged fixture housing into place for easy relamping. For detailed relamping instructions go to www.hewilliams.com.

LABELS

cCSAus certified as luminaire suitable for wet locations.

