

DECORATIVE CAGED GLOBE LUMINAIRE

OGC

SUBMITTAL:

INDUCTION

JOB:

TYPE:

VOLTAGE:

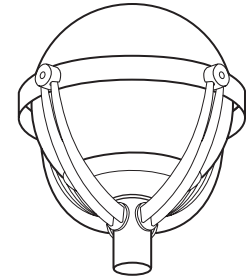

EXAMPLE:

OGC 18 - 85QL120 - 40K - ACR - WHT - T5BL - DBR

SERIES GLOBE SIZE ELECTRICAL PACKAGE COLOR TEMP. GLOBE MATERIAL GLOBE COLOR DIST. FINISH OPTIONS

SERIES

FEATURES

- ▶ 100,000 hour lamp life significantly reduces maintenance where relamping is inconvenient or expensive.
- ▶ Induction lamps provide excellent lumen maintenance—70% at 60,000 hours.
- ▶ 80 color rendering index (CRI).
- ▶ -25°C/-13°F minimum operating ambient temperature, 40°C/104°F maximum operating ambient temperature.
- ▶ Structural cage features decorative medallions and architectural band.
- ▶ Choice of impact-resistant polycarbonate or U.V. stabilized acrylic diffuser.
- ▶ Choice of clear or white globe.

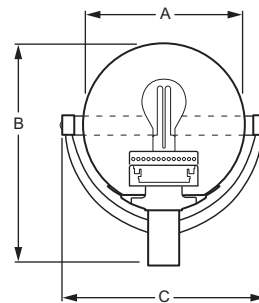

This fixture is proudly made in the USA.



OGC SERIES

Available in 16", 18", or 20" globe sizes.

- FIXTURE BASE** — Cast aluminum base with spun aluminum cover.
- ENCLOSURE** — Impact-resistant polycarbonate or U.V. stabilized acrylic globe. Gasketed for weathertight performance.
- CAGE** — Welded aluminum construction with decorative medallions and cast aluminum slip fitter.

GLOBE SIZE (Must specify)

GLOBE SIZE	A	B	C	EPA	WEIGHT
16	ø16"	21-7/8"	20-3/8"	1.33	27 Lbs.
18	ø18"	23-7/16"	22-3/8"	1.62	28 Lbs.
20	ø20"	25-9/16"	24-3/8"	1.94	28 Lbs.

ELECTRICAL PACKAGE (Must specify)

QL INDUCTION SYSTEM	
55QL120	85QL120
55QL208	85QL208
55QL240	85QL240
55QL277	85QL277

ELECTRICAL PACKAGE

3-piece Philips QL Induction system. Prewired at factory for easy field installation.

LAMP COLOR TEMPERATURE (Must specify)

27K	2700K
30K	3000K
40K	4000K

GLOBE MATERIAL (Must specify)

ACR	Acrylic
CPC	Polycarbonate

GLOBE MATERIAL

Impact-resistant polycarbonate or U.V. stabilized acrylic.

GLOBE COLOR (Must specify)

CLR	Clear
WHT	White

GLOBE COLOR

Available in clear or white.

INDUCTION

DISTRIBUTION

Type V distribution.



T5BL Type V bare lamp

FINISH OPTIONS

Super durable polyester powder coat meets and exceeds AAMA 2604 specifications for outdoor durability.

FINISH OPTIONS (Must specify)

BLK	Black (RAL# 9004)
DBR	Dark bronze (Protech #PC21462)
GRAY	Standard gray (Protech #PC18367)
GRN	Green (RAL# 6005)
SLV	Satin aluminum (RAL# 9006)
WHT	White (RAL# 9003)
RAL# ____	Specify custom color

MOUNTING POINT

Post top mounting on 2-3/8" O.D. tenon or pole top. Secured with stainless steel set screws. See Williams' Poles or Pole Top Assemblies for details.

LABELS

cCSAus certified as luminaire suitable for wet location.

